

# EBENSBURG MAIN STREET DEVELOPMENT

EBENSBURG BOROUGH

CAMBRIA COUNTY, PA

FEDERAL PROJECT NO. Q220-T093-184

**SITE DATA**

1. OWNER: EBENSBURG BOROUGH  
300 WEST HIGH STREET  
EBENSBURG, PA 15931
2. CURRENT LAND USE: EXISTING SIDEWALKS
3. PROPOSED LAND USE: REDEVELOPMENT OF SIDEWALKS

**SHEET INDEX**

- SHEET 1 OF 19 COVER SHEET
- SHEET 2 OF 19 OVERALL SITE PLAN
- SHEET 3 OF 19 QUANTITY SUMMARY
- SHEET 4 OF 19 QUANTITY TABULATIONS
- SHEET 5 OF 19 QUANTITY TABULATIONS
- SHEET 6 OF 19 QUANTITY TABULATIONS
- SHEET 7 OF 19 SITE DETAILS
- SHEET 8 OF 19 SITE DETAILS
- SHEET 9 OF 19 SITE PLAN-NEW SIDEWALK & STREET TREE LAYOUT
- SHEET 10 OF 19 SITE PLAN-NEW SIDEWALK & STREET TREE LAYOUT
- SHEET 11 OF 19 SITE PLAN-NEW SIDEWALK & STREET TREE LAYOUT
- SHEET 12 OF 19 SIGNAL CONTROL PLAN
- SHEET 13 OF 19 TRAFFIC CONTROL PLAN
- SHEET 14 OF 19 TRAFFIC CONTROL PLAN
- SHEET 15 OF 19 TRAFFIC CONTROL PLAN
- SHEET 16 OF 19 TRAFFIC CONTROL PLAN
- SHEET 17 OF 19 LIGHTING LEGEND, ABBREVIATIONS AND GENERAL NOTES
- SHEET 18 OF 19 ELECTRICAL LIGHTING PLAN
- SHEET 19 OF 19 ELECTRICAL DETAILS

**GENERAL NOTES**

- A. ON OCT. 1, 2005 THE CONTRACTOR SHALL NOT WORK BECAUSE OF BOROUGH OF EBENSBURG FESTIVITIES. ON THE LAST WORKING DAY PRIOR TO THESE DATE, THE CONTRACTOR SHALL SECURE WORK EFFECTIVELY WITH BARRICADES AND OR FENCING FOR SAFETY PRECAUTIONARY MEASURES. THE CONTRACTOR MUST ALSO CLEAN AREA OF WORK AND TEMPORARILY RELOCATE EQUIPMENT PER DIRECTIONS FROM THE BOROUGH MANAGER.
- B. APPROPRIATELY SIZED PLASTIC SLEEVES SHALL BE PLACED IN CONCRETE SIDEWALK AND/OR (PATTERNED CONCRETE) FOR NEW PARKING METERS, BASED ON LOCATION AS DESCRIBED BY THE BOROUGH MANAGER.
- C. CONTRACTOR SHALL REMOVE ALL EXISTING TREES AND PLANTER BOXES PER DIRECTION OF THE BOROUGH MANAGER PRIOR TO CONSTRUCTION UNLESS DIRECTED OTHERWISE BY BOROUGH MANAGER.  
NOTE: TWO TREES IN FRONT OF NOON COLLINS INN SHALL REMAIN. THE SAME PAVING DESIGN SHOWN FOR NEW TREES SHALL BE PLACED AROUND EXISTING REMAINING TREES.
- D. CONTRACTOR SHALL PROVIDE 4" MINIMUM DEPTH OF FINE GRADE TOPSOIL IN AREAS DESIGNATED AS LAWN AREAS IN PLAN. THIS AREA SHALL ALSO BE SEEDED IN ACCORDANCE TO PADOT SPECIFICATION 408 USING FORMULA B SEEDING MIXTURE.
- E. DURING CONSTRUCTION PERIODS, CONTRACTOR MUST PLAN AND PROVIDE TEMPORARY PEDESTRIAN ACCESS TO THE FRONT DOOR OF EACH AFFECTED BUSINESS AND/OR PROPERTY OWNER. THESE PROVISIONS MUST BE SAFE. CONTRACTOR SHALL NOTIFY ALL BUSINESS OWNERS AND PROPERTY OWNER AT LEAST 3 WEEKS PRIOR TO SIDEWALK CONSTRUCTION SO TEMPORARY INTERRUPTION OF BUSINESSES ARE PLANNED ACCORDINGLY. ALSO SEE TOP SHEET 13 OF 19.
- F. ALL ELECTRICAL CONDUIT AND LIGHT BOXES SHALL BE A COORDINATED INSTALLATION WITH PENELEC
- G. PRIOR TO SIDEWALK CONSTRUCTION AND DEMOLITION OF EACH AREA, THE CONTRACTOR SHALL DISCUSS THE PRIVATE ENTRY WAYS TO EACH BUSINESS OR RESIDENCE TO SEE IF OWNER WANTS CONTRACTOR TO REMOVE AND REPLACE THEIR ENTRY WAY AND/OR STEPS. IF THE OWNER WANTS THEIR PRIVATE ENTRANCE REPLACED THE CONTRACTOR SHALL PRESENT A FEE TO EACH PROPERTY OWNER. THE OWNERS WILL BE RESPONSIBLE FOR THE COST OF ALL PRIVATE ENTRY WAY CONSTRUCTION.

**LIST OF PUBLIC UTILITIES**

- SANITARY SEWER**  
EBENSBURG MUNICIPAL AUTHORITY  
300 WEST HIGH STREET  
EBENSBURG, PA 15931  
PHONE: 814-472-7811  
ATTN: JEFF EVANS
- WATER**  
EBENSBURG MUNICIPAL AUTHORITY  
300 WEST HIGH STREET  
EBENSBURG, PA 15931  
PHONE: 814-472-7811  
ATTN: JEFF EVANS
- GAS**  
DOMINION PEOPLES  
3115 ELTON ROAD  
JOHNSTOWN, PA 15904  
PHONE: 814-289-6327  
ATTN: DENNY DEVLIN
- ELECTRIC**  
PENELEC - FIRST ENERGY CORP.  
367 INDUSTRIAL PARK ROAD  
EBENSBURG, PA 15931  
PHONE: 814-471-8021  
ATTN: SYD ATHERTON
- TELEPHONE**  
VERIZON  
1119 16TH 3RD FLOOR  
ALTOONA, PA 16601  
PHONE: 814-940-2650  
ATTN: BRIAN TELEK
- CABLE TELEVISION**  
ADELPHIA  
1155 PLANK ROAD  
CARROLLTOWN, PA 15722  
PHONE: 814-344-8055 EXT. 134  
ATTN: BILL IKES

**SITE PLAN LAYOUT SHEET INDEX**

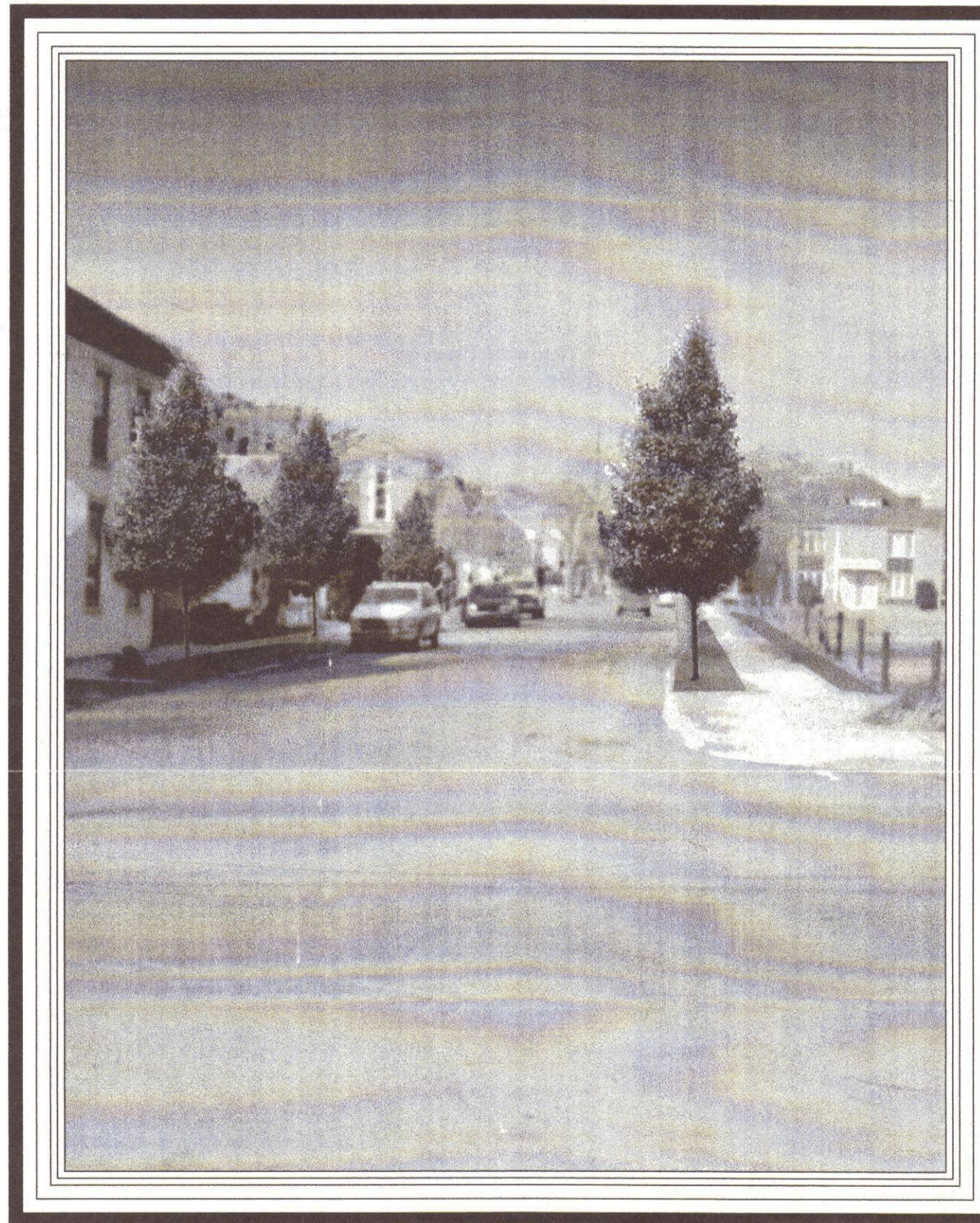
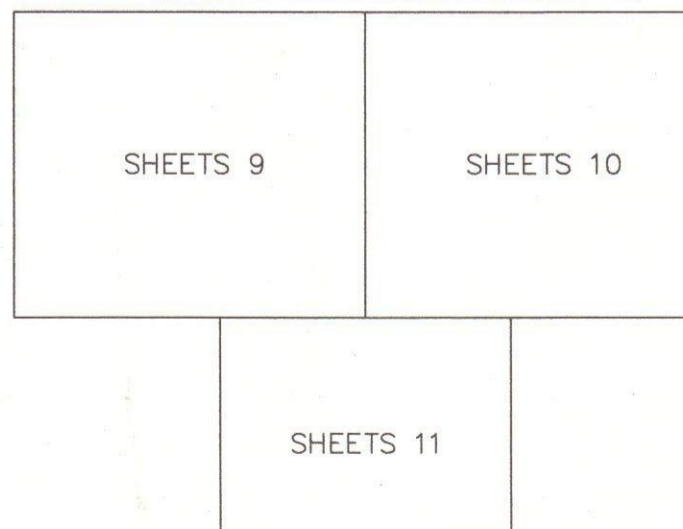

**GENERAL NOTES**

1. DO NOT SCALE DRAWINGS.
2. PRIOR TO CONSTRUCTION, CONTRACTOR SHALL VERIFY FROM THE CONSTRUCTION DRAWINGS ALL DIMENSIONS, DETAILS AND TREATMENTS FOR THE SIDEWALKS AND FOR OTHER CONSTRUCTION WHERE INDICATED ON PLAN. THE CONTRACTOR SHALL WALK AND REVIEW WORK LIMITS WITH BOROUGH MANAGER.
3. CONTRACTOR SHALL CONFORM TO ALL APPLICABLE FEDERAL, STATE AND LOCAL STANDARDS, SPECIFICATIONS, AND REQUIREMENTS CURRENTLY ENFORCED DURING THE CONSTRUCTION PERIOD.
4. ALL EXISTING PAVEMENT DAMAGED BY NEW CONSTRUCTION SHALL BE REPAIRED PER STANDARD PADOT CONSTRUCTION PRACTICES AND SPECIFICATIONS.
5. EXISTING ROADS SHALL BE MAINTAINED IN A CLEAN CONDITION; MUD, STONE AND DUST FREE AT ALL TIMES. ADEQUATE MEANS SHALL BE PROVIDED TO CLEAN THE WHEELS OF ALL VEHICLES EXITING THE SITE PRIOR TO ACCESSING PUBLIC THROUGHFARES.
6. CONTRACTOR MUST CONTACT THE "PENNSYLVANIA ONE CALL SYSTEM" AT 800-242-1776 AT LEAST 3 WORKING DAYS PRIOR TO CONSTRUCTION. DESIGN ONE CALL NO. FOR HIGH STREET IS 0631212 AND 0631206 FOR CENTER STREET.
7. EXISTING UTILITY LOCATIONS ARE APPROXIMATE ONLY. CONTRACTOR SHALL CONTACT ALL UTILITY COMPANIES LISTED TO VERIFY LOCATIONS AND SHALL LOCATE ALL UNDERGROUND UTILITIES BY TEST PITS. CONTRACTOR TO CONTACT RESPECTIVE UTILITY COMPANIES AND ENGINEER IF CONFLICT SHOULD ARISE.
8. THE GENERAL CONTRACTOR IS DESIGNATED AS THE "RESPONSIBLE PERSON IN CHARGE OF CONSTRUCTION" AND THE SITE SUPERVISOR, WHO HAS BEEN SAFETY TRAINED AND CERTIFIED IN THE WORK BEING PERFORMED, IS RESPONSIBLE FOR CONSTRUCTION SITE SAFETY.
9. THE SITE CONTRACTOR SHALL COORDINATE WITH THE ELECTRICAL CONTRACTOR FOR CONSTRUCTION OF ELECTRICAL CONDUITS, SITE LIGHTING AND OTHER CONSTRUCTION ITEMS RELATIVE TO ANY SITE ELECTRICAL WORK THAT MAY BE IN CONFLICT WITH THE SITE CONSTRUCTION WORK.
10. CONTRACTOR SHALL COORDINATE WITH THE UTILITY COMPANY FOR ANY SERVICE CONNECTIONS TO THEIR RESPECTIVE UTILITIES.
11. ALL EXISTING CURB AND SIDEWALK THAT ARE TO BE DEMOLISHED SHALL BE REMOVED FROM SITE AND DISPOSED OF IN ACCORDANCE TO EBENSBURG BOROUGH ORDINANCE.
12. SEE THE MAINTENANCE AND PROTECTION OF TRAFFIC SPECIAL PROVISION FOR BUSINESS AND RESIDENCE ACCESS REQUIREMENTS AND FOR PEDESTRIAN MAINTENANCE AND PROTECTION OF TRAFFIC REQUIREMENTS.
13. CONTRACTOR SHALL PROVIDE TRAFFIC CONTROL IN ACCORDANCE WITH PADOT - PUBLICATION 203 WORK ZONE TRAFFIC CONTROL CRITERIA AND SPECIFICATIONS AND THE APPROVED TRAFFIC CONTROL PLAN.
14. CONTRACTOR SHALL PROVIDE ANY AND ALL SAFETY PRECAUTIONARY MEASURES NECESSARY FOR THE SAFETY OF PEDESTRIANS DURING THE CONSTRUCTION PROCESS.
15. ALL POSTS, SIGNS, AND ANY OTHER EXISTING SITE FEATURES SHALL BE REMOVED PER DIRECTION OF BOROUGH OF EBENSBURG.
16. ALL PAVING AND CURB SHALL BE REMOVED TYPICALLY TO THE NEAREST JOINT.
17. SITE MAPPING OF THIS PROJECT IS COMPLETE ENOUGH FOR GENERAL PURPOSES ONLY. CERTAIN SITE SPECIFIC ADJUSTMENTS WILL NEED TO BE MADE DURING THE CONSTRUCTION PROCESS. THE BOROUGH OF EBENSBURG IS PREPARED TO PROVIDE, TO THE BEST OF THEIR ABILITY, A CONSTRUCTION LIAISON TO HELP MANAGE THE CONSTRUCTION OF THE PROJECT AND FACILITATE GENERAL CONSTRUCTION.
18. SEE ALL CONSTRUCTION DETAILS FOR TYPICAL SIDEWALK, HANDICAPPED ACCESSIBLE RAMP, CURB CONSTRUCTION AND TREE INSTALLATION DETAILS.
19. ALL BENCHES SHOWN ON PLAN ARE NOT IN CONTRACT. THEY SHALL BE PURCHASED AND INSTALLED BY BOROUGH EMPLOYEES AS DIRECTED BY BOROUGH MANAGER.
20. ALL STREET PRINT ASPHALT PAVING AND PATTERNED CONCRETE PAVING SHALL BE INSTALLED IN ACCORDANCE TO MANUFACTURER AND SUPPLIER DETAILS AND SPECIFICATIONS.
21. THIS PROJECT MAY BE A PHASED CONSTRUCTION PROJECT AS DIRECTED BY THE BOROUGH OF EBENSBURG.
22. ELECTRICAL CONDUIT SHALL BE PLACED UNDER NEW SIDEWALKS PRIOR TO CONSTRUCTION.
23. BASE MAPPING WAS PREPARED FROM EXISTING AERIAL PHOTOGRAPHY DATED NEAR 1992.
24. CONTRACTOR WILL NEED TO ADD NEW ROOF DRAIN PIPES THROUGH SIDEWALKS AS NECESSARY IN ACCORDANCE TO BOROUGH OF EBENSBURG.
25. CATCH BASINS AND CULVERT INLETS SHALL BE PROTECTED WITH GEOTEXTILE MATERIAL OR STRAW BALES USED FOR EROSION AND SEDIMENTATION CONTROL.
26. THE CONTRACTOR IS RESPONSIBLE FOR RESTORING ALL DISTURBED PROPERTY TO CONDITIONS EQUAL TO OR BETTER THAN CONDITIONS PRIOR TO CONSTRUCTION.
27. ALL ELEVATIONS AND GRADES MUST HAVE A POSITIVE FLOW FROM BUILDING ACCESS WAYS AT 2.0% SLOPE ACROSS SIDEWALKS AS DIRECTED BY EBENSBURG BOROUGH ORDINANCES.
28. ALL PROPERTY AND BUSINESSES SHOWN ON PLAN MAY NOT BE CURRENT.
29. ALL WORK IN PADOT RIGHT-OF-WAY IS TO BE BUILT ACCORDING TO:
  - A. PA. DOT PUBLICATION NO. 408/2003, SPECIFICATIONS
  - B. PA. DOT PUBLICATION NO. 35, APPROVED CONSTRUCTION MATERIALS (BULLETIN 15).
  - C. PA. DOT PUBLICATION NO. 72, STANDARDS FOR ROADWAY CONSTRUCTION.
30. THE CONTRACTOR IS RESPONSIBLE TO MAINTAIN ALL EXISTING SIGNS AND PAVEMENT MARKINGS.
31. IF A TRAFFIC SIGNAL IS WITHIN 500 FEET OF THE SITE, CALL THE DISTRICT TRAFFIC ENGINEER AT 814-696-7238 AT LEAST 3 DAYS PRIOR TO THE START OF WORK.
32. THE TREES SHALL BE PLACED WITHIN THE SIDEWALKS WITH REGARD TO THE CURRENT PARKING SPACE ALIGNMENT SO THERE ARE NO OBSTRUCTIONS WITH PARKED CAR DOOR OPENINGS. PRIOR TO TREE INSTALLATION, CONTRACTOR SHALL NOTIFY LANDSCAPE ARCHITECT AND/OR BOROUGH TO COORDINATE TREE INSTALLATION TO VALIDATE IF EITHER THE TREE LOCATION OR THE PARKING SPACES NEED ADJUSTMENT.
33. IT IS THE CONTRACTOR'S RESPONSIBILITY TO MODIFY, RELOCATE OR REPLACE ANY SIGNAL EQUIPMENT BOXES, UNDERGROUND OR ABOVE GROUND WIRING, ETC. DAMAGED DURING THE CONSTRUCTION OF THIS PROJECT. A SIGNAL PLAN HAS BEEN ATTACHED TO THIS PLAN FOR THE CONTRACTOR'S INFORMATION. IT IS ANTICIPATED THAT ALL JUNCTION BOXES, THE INSTALLATION OF 1" AND 2" CONDUIT AND LEAD WIRE FOR THE LOOP SENSORS WILL BE REQUIRED. THE CONTRACTOR IS TO MAKE REPAIRS AS REQUIRED, TAKING CARE NOT TO DAMAGE WORK COMPLETE AND NOT INTERFERE WITH WORK REMAINING ON THE PROJECT.



<p>PREPARED BY</p> <p><b>L. ROBERT KIMBALL &amp; ASSOCIATES, INC.</b> CONSULTING ENGINEERS &amp; ARCHITECTS 615 WEST HIGHLAND AVE. EBENSBURG, PA. 15931 PHONE (814)472-7700 FAX (814)472-7712</p> <p><i>Cameron R. Mock</i> Cameron R. Mock, P.E.</p> <p>DATE: 12-8-04</p>	<p>APPROVED BY</p> <p>Borough of Ebensburg</p> <p><i>[Signature]</i> DATE: 12/14/04 Borough Manager</p> <p>RECOMMENDED DATE: 12/6/04</p> <p><i>[Signature]</i> DISTRICT EXECUTIVE</p> <p>(ON BEHALF OF THE GOVERNOR AS WELL AS HIMSELF)</p>
--	---

066-5834 Ki  
9.5  
6







# ROADWAY SUMMARY

**Kimball**  
L. Robert Kimball & Associates  
615 West Highland Ave.  
Ebensburg, Pa. 15931  
phone (814) 472-7700  
fax (814) 472-7712  
email candr@kimball.com  
web site www.lrkimball.com

CONSULTANT'S

**EBENSBURG  
MAIN  
STREET  
DEVELOPMENT**  
EBENSBURG BOROUGH  
CAMBRIA COUNTY, PA

PROJECT NAME

EBENSBURG, PA

OWNER

REV	DATE	DESCRIPTION
△	09/21/04	RE-BID
ISSUE	03/08/04	
PROJECT NO	03-1300-0377	
SCALE	NOT TO SCALE	
DRAWN BY:	NLS	
CHECKED BY:	GLH	

L. Robert Kimball & Associates

SHEET TITLE

## QUANTITY SUMMARY

QUANTITY	ITEM NUMBER	DESCRIPTION	DESIGN NUMBER	FOR TAB SEE SHEET	QUANTITY	ITEM NUMBER	DESCRIPTION	DESIGN NUMBER	FOR TAB SEE SHEET	QUANTITY	ITEM NUMBER	DESCRIPTION	DESIGN NUMBER	FOR TAB SEE SHEET	QUANTITY	ITEM NUMBER	DESCRIPTION	DESIGN NUMBER	FOR TAB SEE SHEET
235	0203 0004 CY	CLASS 1B EXCAVATION		4 & 6	3	9606 0250 SET	GRADE ADJUSTMENT OF EXISTING SIDEWALK BASEMENT ACCESS HATCHES		4	1768	0962 1005 SF	4" YELLOW WATERBORNE PAVEMENT MARKINGS		5	344 ♦	9720 0001 SF	DETECTABLE WARNING PAVERS		5
378	0309 0030 SY	SUPERPAVE ASPHALT MIXTURE DESIGN, HMA BASE COURSE, PG 58-28, < 3 MILLION ESALS, 25.0 MM MIX 8" DEPTH		4 & 6	2	9607 0100 EACH	MAIL BOX (RELOCATIONS AS NEEDED)		4	3855	0962 1000 SF	4" WHITE WATERBORNE PAVEMENT MARKINGS		5	68 ♦	9735 0001 SY	STABILIZER FABRIC (UNDER CONCRETE PAVERS)		5
540	0309 0033 SY	SUPERPAVE ASPHALT MIXTURE DESIGN, HMA BASE COURSE, PG 58-28, < 3 MILLION ESALS, 25.0 MM MIX 9.5" DEPTH			6	9607 0101 EACH	NEWSPAPER VENDING STANDS (RELOCATION AS NEEDED)		4	720	0962 1001 SF	6" WHITE WATERBORNE PAVEMENT MARKINGS		5	122 ♦	9803 0001 CY	TOPSOIL - 1 UNIT PEAT TO 5 UNITS TOPSOIL		5
3839	0350 0104 SY	SUBBASE 4" DEPTH (NO. 2A)		4	4097	0630 0010 LF	PLAIN CEMENT CONCRETE CURB, INCLUDING REMOVAL OF EXISTING CURB		4	100	0963 0001 SF	PAVEMENT MARKING REMOVAL		NO TAB	153 ♦	9803 0002 CY	TOPSOIL (COMPACTED)		5
939 ♦	0350 0106 SY	SUBBASE 6" DEPTH (NO. 2A)		4	2794	0676 0001 SY	CEMENT CONCRETE SIDEWALK		4	---	9000 0001 EACH	COMPONENT ITEM STREET LIGHTING		3	31 ♦	9803 0003 CY	COMPACTED SOIL (UNDER TREES)		5
3786	0409 0442 SY	SUPERPAVE ASPHALT MIXTURE DESIGN, HMA WEARING COURSE, PG 64-22, 0.3 TO < 3 MILLION ESALS, 12.5 MM MIX, 1.5" DEPTH SRL-H		4	48	0802 0001 CY	TOPSOIL FURNISHED AND PLACED		4	1 ♦	9000 0002 EACH	RELOCATE BUS SHELTER		5	29 ♦	9808 0552 EACH	TREE - CLEVELAND SELECT (4 1/2" CAL. B&B, INSTALLATION ONLY)		5
3584	0460 0001 SY	BITUMINOUS TACK COAT		4	7	0804 0011 LB	SEEDING AND SUPPLEMENTS - FORMULA B		4	---	9000 0003 EACH	COMPONENT ITEM CHERRY STREET		6	32 ♦	9808 0553 EACH	TREE - REDSPIRE PEAR(4 1/2" CAL. B&B, INSTALLATION ONLY)		5
1774	0469 0012 LF	POLYMER MODIFIED ASPHALT JOINT AND CRACK SEALING FOR BITUMINOUS SURFACES		4	7	0805 0019 SY	MULCHING - WOOD CHIPS, 3" DEPTH		4	365 ♦	9409 0442 SY	STAMPED PATTERNED ASPHALT		5	13 ♦	9931 0001 EACH	RESET POST MOUNTED SIGNS, TYPE B		5
3584	0491 0070 DEPTH	MILLING OF BITUMINOUS PAVEMENT SURFACE, VARIABLE DEPTH		4	1	0805 0022 SY	MULCHING - STRAW		4	1333 ♦	9501 0020 SY	4" PATTERNED CONCRETE SIDEWALK		5	40 ♦	9933 0001 EACH	PARKING METERS		6
606	0501 0128 SY	H.E.S. PLAIN CEMENT CONCRETE PAVEMENT, 8" DEPTH		4	12	0808 6000 M GAL	WATERING		4	342 ♦	9501 0128 SY	H.E.S. PLAIN CEMENT CONCRETE PAVEMENT, 8" DEPTH (PATTERNED CROSSWALK)		5	55 ♦	9933 0004 EACH	REMOVE FLAG STANDS AND PARKING METERS		6
2	0606 0050 SET	GRADE ADJUSTMENT OF EXISTING INLETS		4	14	0810 0052 EACH	SELECTIVE TREE REMOVAL		5	40 ♦	9617 0001 LF	4" TRENCH DRAIN (NOON-COLLINS INN)		5	50 ♦	9962 0020 LF	CURB PAINTING (BLUE) HANDICAP PARKING		6
5	0606 0150 SET	GRADE ADJUSTMENT OF EXISTING MANHOLES		4	PDA	0845 0002 PDA	UNFORESEEN WATER POLLUTION CONTROL		NO TAB	36 ♦	9705 0001 CY	CONCRETE LEVELING COURSE (UNDER CROSSWALK)		5	2 ♦	9962 0030 EACH	HANDICAP PARKING - WHEELCHAIR SYMBOL		6
1	9606 0160 SET	GRADE ADJUSTMENT OF EXISTING SIDEWALK BASEMENT VENT		4	1	0901 0001 LS	MAINTENANCE & PROTECTION OF TRAFFIC DURING CONSTRUCTION		NO TAB	109 ♦	9713 0001 SY	12" x 12" x 3" CONCRETE PAVERS (AROUND TREES) (INCLUDES 2 EXISTING TREES AT NOON COLLINS INN)		5	770 ♦	9962 0232 LF	CURB PAINTING (YELLOW) NO PARKING		6
1	9606 0170 SET	GRADE ADJUSTMENT OF EXISTING WATER METER PIT COVER		4	100	0901 0240 SF	ADDITIONAL TRAFFIC CONTROL SIGNS		13	54 ♦	9713 0002 SY	8" x 4" x 2.25" BRICK PAVERS (AROUND TREES)		5					
3	9606 0200 SET	GRADE ADJUSTMENT OF EXISTING TRAFFIC SIGNAL CONTROL COVERS		4	2	0901 0202 EACH	FLOODLIGHTS		13										

**LEGEND**  
♦ SPECIAL PROVISIONS ITEMS

## STREET LIGHTING SUMMARY

QUANTITIES INCLUDED IN ITEM 9000-0001

QUANTITY	ITEM NUMBER	DESCRIPTION	DESIGN NUMBER	FOR TAB SEE SHEET
57 ♦	9910 0152 EACH	POLE FOUNDATION		NO TAB
49 ♦	9910 0001 EACH	ALUMINUM STREET LIGHT, TYPE A		NO TAB
8 ♦	9910 0002 EACH	ALUMINUM STREET LIGHT, TYPE B		NO TAB
750 ♦	9910 4056 LF	AWG 8 DB ELECTRICAL CABLE, COPPER, 1 CONDUCTOR		NO TAB
7,500 ♦	9910 4057 LF	AWG 10 DB ELECTRICAL CABLE, COPPER, 1 CONDUCTOR		NO TAB
19,500 ♦	9910 4058 LF	AWG 12 DB ELECTRICAL CABLE, COPPER, 1 CONDUCTOR		NO TAB
9,000	0910 5053 LF	1 1/2" DIRECT BURIAL CONDUIT		NO TAB
500	0910 5055 LF	2" DIRECT BURIAL CONDUIT		NO TAB
500	0910 5059 LF	3" DIRECT BURIAL CONDUIT		NO TAB
3,500	0910 6000 LF	TRENCH		NO TAB
3	0910 7020 EACH	COMPLETE POWER SUPPLY SYSTEM		NO TAB
1	0910 7210 LS	TESTING OF ENTIRE LIGHTING SYSTEM		





TABULATION OF COMPONENT ITEM CHERRY STREET  
 QUALITIES INCLUDED IN ITEM 9000-0003

ITEM NUMBER	UNIT	REMARKS	SIDE	STATIONS	ROUTE
9933 0001	EACH	PARKING METERS			
9933 0004	EACH	REMOVE FLAG STANDS AND PARKING METERS			
9982 0020	LF	CURB PAINTING (BLUE) HANDICAP PARKING			
9982 0030	EACH	HANDICAP PARKING - WHEELCHAIR SYMBOL			
9982 0232	LF	CURB PAINTING (YELLOW) NO PARKING			
		WEST HIGH ST. (N. BEACHCH TO N. JULIAN )	LT.	108+77 to 111+67	S.R.4031
		WEST HIGH ST. (S. BEECH ST. TO S. JULIAN )	RT	108+77 to 111+67	S.R.4031
4	7	WEST HIGH STREET (N.JULIAN TO N.CHERRY)	LT	111+67 to 114+60	S.R.4031
4	5	WEST HIGH STREET (S.JULIAN TO S.CHERRY)	RT	111+67 to 114+60	S.R.4031
4	5	WEST HIGH STREET (N.CHERRY TO N.CENTER)	LT	114+60 to 117+71	S.R.4031
4	4	WEST HIGH STREET (S.CHERRY TO S.CENTER)	RT	114+60 to 117+71	S.R.4031
	1	EACHST HIGH STREET (N.CENTER TO N.LOCUST)	LT.	300+00 to 303+07	S.R.1036
4	4	EACHST HIGH STREET (S.CENTER TO S.LOCUST)	RT	300+00 to 303+07	S.R.1036
		EACHST HIGH STREET (S.LOCUST TO UNITED CH.)	LT	303+07 to 304+77	S.R.1036
		EACHST HIGH STREET (S.LOCUST TO HOME D.C.)	RT	303+07 to 304+77	S.R.1036
4	5	SOUTH CENTER STREET (W.OGLE TO W.LLOYD)	LT	400+00 to 403+00	S.R.2013
		SOUTH CENTER STREET (E.OGLE TO E.LLOYD)	RT	400+00 to 403+00	S.R.2013
4	5	SOUTH CENTER STREET (W.LLOYD TO W.HIGH)	LT	403+00 to 406+35	S.R.2013
4	5	SOUTH CENTER STREET (E.LLOYD TO E.HIGH)	RT	403+00 to 406+35	S.R.2013
4	7	NORTH CENTER STREET (W.HIGH TO W.SAMPLE)	LT	200+00 to 203+17	S.R.4031
4	7	NORTH CENTER STREET (E.HIGH TO E.SAMPLE)	RT	200+00 to 203+17	S.R.4031
40	55			770	

CLASS	EXCAVATION	ITEM NUMBER	UNIT	REMARKS	SIDE	STATIONS	ROUTE
0303	0004	CY					
0350	0106	SY					
0309	0023	SY					
0409	0442	SY					
0460	0001	SY					
0409	0442	SY					
12.0	23.0	23.0					
20.0	40.0	40.0	40.0	40.0			
32.0	63.0	23.0	1846	1846	1806		

**Kimball**  
 L. Robert Kimball & Associates  
 615 West Highland Ave.  
 Ebensburg, Pa. 15931  
 phone (814) 472-7700  
 fax (814) 472-7712  
 email oand@kimball.com  
 web site www.lrkimball.com

CONSULTANTS

**EBENSBURG  
 MAIN  
 STREET  
 DEVELOPMENT**  
 EBENSBURG BOROUGH  
 CAMBRIA COUNTY, PA

PROJECT NAME

EBENSBURG, PA.

OWNER

REV	DATE	DESCRIPTION
	09/21/04	RE-BID
	03/08/04	ISSUE
	03-1300-0377	PROJECT NO
	NOT TO SCALE	SCALE
	NLS	DRAWN BY
	GLH	CHECKED BY

L. Robert Kimball & Associates

SHEET TITLE

**QUANTITY  
 TABULATIONS**

Sheet 6 of 19

CONSULTANT'S

**EBENSBURG  
MAIN  
STREET  
DEVELOPMENT**  
EBENSBURG BOROUGH  
CAMBRIA COUNTY, PA

PROJECT NAME

EBENSBURG, PA.

OWNER

REV	DATE	DESCRIPTION
09/21/04	RE-BID	
03/08/04		ISSUE
03-1300-0377		PROJECT NO.
NOT TO SCALE		SCALE
NLS		DRAWN BY
GLH		CHECKED BY

L. Robert Kimball & Associates

SHEET TITLE

**SITE  
DETAILS**

**LANDSCAPE NOTES**

1. ALL PLANT MATERIAL AND INSTALLATION OF PLANT MATERIAL SHALL BE IN STRICT CONFORMANCE WITH THE MOST RECENT EDITION OF THE AMERICAN STANDARD FOR NURSERY STOCK OF THE AAN AND THE ANS 280.1 USDA AND AJOH.
2. CONTRACTOR SHALL VERIFY ALL UTILITIES WITHIN WORK AREA AND SHALL BE RESPONSIBLE FOR THEIR PROTECTION.
3. TREE LOCATIONS MAY NEED TO BE ADJUSTED BASED ON LOCATIONS OF UTILITIES.
4. NO IRRIGATION SYSTEM IS REQUIRED BUT TREES MUST BE WATERED GENEROUSLY AFTER PLANTING AND SHOULD BE MAINTAINED AND WATERED AFTER PLANTING UNTIL TREES ARE HEALTHY.
5. ALL PLANTING BEDS TO RECEIVE 3" SHREDDED HARDWOOD MULCH AS SHOWN ON PLANS.
6. WHEN PLANTING B & B PLANT MATERIAL CUT BINDING MATERIAL AT TOP. REMOVE TOP 1/3 OF BURLAP. NON-Biodegradable MATERIAL SHALL BE TOTALLY REMOVED.
7. DO NOT ALLOW AIR POCKETS TO FORM WHEN BACKFILLING.
8. THE CONTRACTOR SHALL SUPPLY ALL PLANT MATERIAL IN QUANTITIES SUFFICIENT TO COMPLETE THE PLANTING SHOWN ON ALL DRAWINGS THAT TAKES A MAXIMUM OF ONLY 1 WEEK TO PLANT. ARRANGEMENTS MAY BE MADE WITH THE BOROUGH IF HEALING-TIME OF PLANTS IS LONGER THAN 1 WEEK. TREES SHOULD NOT BE STORED ON ASPHALT.
9. NO PLANT SHALL BE PLACED IN THE GROUND BEFORE FINAL PLANTING PIT HAS BEEN COMPLETED AND APPROVED BY THE PROJECT LANDSCAPE ARCHITECT OR THE OWNERS REPRESENTATIVE.
10. ALL PLANTS SHALL HAVE THE SAME RELATIONSHIP TO FINISHED GRADE (OR SLIGHTLY HIGHER) AS THE PLANTS ORIGINAL GRADE BEFORE UPGRADE. THEY SHALL BE FREE FROM DEFECTS AND INJURIES AND CERTIFIED BY APPROPRIATE FEDERAL AND STATE AUTHORITIES TO BE FREE FROM INSECT INFESTATIONS AND DISEASES.
11. TREES PLANTED ALONG SIDEWALKS, PEDESTRIAN ACCESSES AND RIGHT-OF-WAYS SHALL HAVE A STRAIGHT TRUNK AND BRANCHES THAT SHALL BE KEPT TRIMMED (8) NINE FEET ABOVE ANY SIDEWALK AND (11) ELEVEN FEET ABOVE ALL STREETS.
12. ALL PLANTS SHALL BE BALLED AND WRAPPED OR CONTAINER GROWN AS SPECIFIED. NO CONTAINER GROWN STOCK WILL BE ACCEPTED IF IT IS ROOT BOUND. ALL ROOT WRAPPING MATERIAL MADE OF SYNTHETICS OR PLASTICS SHALL BE REMOVED AT TIME OF PLANTING.
13. WITH CONTAINER GROWN STOCK, THE CONTAINER SHALL BE REMOVED AND THE CONTAINER BALL CUT THROUGH THE SURFACE IN TWO VERTICAL LOCATIONS.
14. PRIOR TO PLANTING OF ANY TREES, THE LOCATION OF ALL TREES SHALL BE MARKED FOR APPROVAL BY THE PROJECT LANDSCAPE ARCHITECT OR OWNERS REPRESENTATIVE.
15. ALL PLANT MATERIAL SHALL BE TYPICAL OF THEIR SPECIES AND VARIETY, HAVE NORMAL GROWTH HABITS, WELL DEVELOPED, DENSELY FOLIATED BRANCHES, AND VIGOROUS ROOT SYSTEMS.
16. AT PLANTING TIME, ALL PLANT MATERIAL SHALL BE THINNED BY REMOVING BROKEN AND/OR DEAD VEGETATIVE MATERIAL INCLUDING BRANCHES AND ROOTS WITH APPROPRIATE SHARP TOOLS.
17. ALL PLANTS SHALL BE SPRAYED WITH AN ANTIDESICCANT WITHIN 24 HOURS OF PLANTING. ALL PLANTS SHALL ALSO BE SPRAYED WITH AN ANTIDESICCANT AT THE BEGINNING OF THEIR FIRST WINTER.
18. ALL PLANTS SHALL BE INSTALLED AS PER DETAILS IN THE CONTRACT DRAWINGS.
19. ALL PLANTS SHALL BE PLUMB UNLESS OTHERWISE SPECIFIED.
20. THE LANDSCAPE CONTRACTOR SHALL PROVIDE LOAM FILL (FINE GRADE TOPSOIL) AND PEAT MOSS FOR THE PLANTS AS PER THE CONTRACT DRAWINGS.
21. ALL PLANTS SHALL BE THOROUGHLY WATERED TWICE DURING THE FIRST 24 HOUR PERIOD AFTER PLANTING. ALL PLANTS SHALL THEN BE WATERED WEEKLY OR MORE OFTEN, IF NECESSARY, DURING THE FIRST GROWING SEASON.
22. THE LANDSCAPE CONTRACTOR SHALL REFER TO THE PLANTING SCHEDULE FOR TYPES OF PLANTS AND OTHER PERTINENT INFORMATION REGARDING PLANT CHARACTERISTICS.
23. ALL TREES SHALL BE HANDLED WITH CARE AT THE TIME OF PLANTING. TREES SHALL NOT BE DROPPED OR MISPLANTED DURING PLANTING TIME OR PLANTED IN UNUSUAL CONDITIONS EXCEEDING 15 MPH.
24. ALL TREES SHALL HAVE A 1 YEAR WARRANTY FROM THE TIME OF PLANTING AND SHALL BE REPLACED BY THE CONTRACTOR IF THEY DO NOT SURVIVE THE FIRST YEAR.

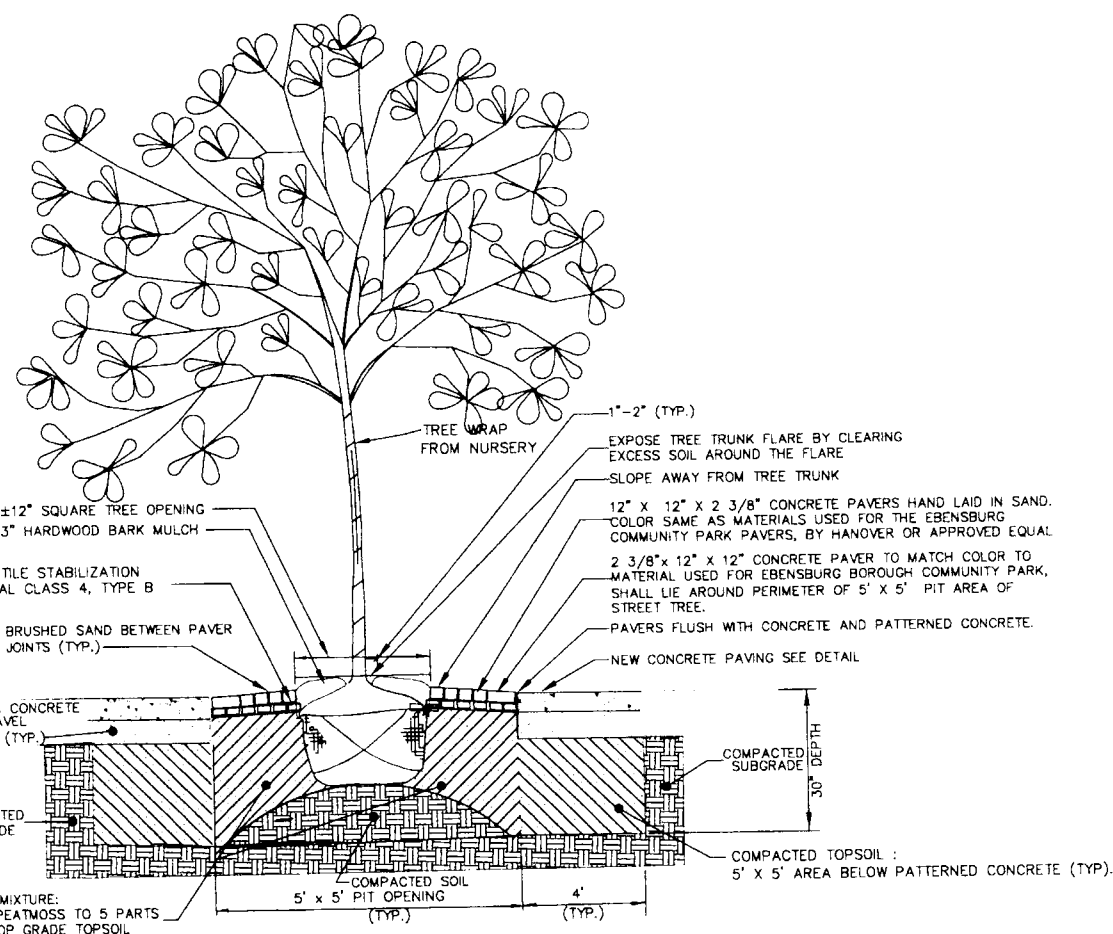

**DECIDUOUS TREE PLANTING DETAIL FOR STREETScape DEVELOPMENT**  
N.T.S.

- NOTES**
1. BREAK UP EXISTING SUBGRADE 1'-1.5' AROUND THE PERIMETER OF TREE PIT FOR SOIL AERATION AND ROOT GROWTH STIMULATION.
  2. FREE LAID PAVERS SHALL BE LAID SLIGHTLY HIGHER THAN ADJACENT CONCRETE TO ALLOW FOR SETTLING OF TOPSOIL. THE SURFACE SHALL SLOPE AWAY FROM THE TRUNK OF THE TREE.
  3. TREE TRUNK SHALL BE WRAPPED WITH TREE WRAPPING MATERIAL WHEN PLANTED FOR CONSTRUCTION DAMAGE PROTECTION. TREE WRAP MUST BE REMOVED BY CONTRACTOR PRIOR TO COMPLETION OF THE PROJECT.

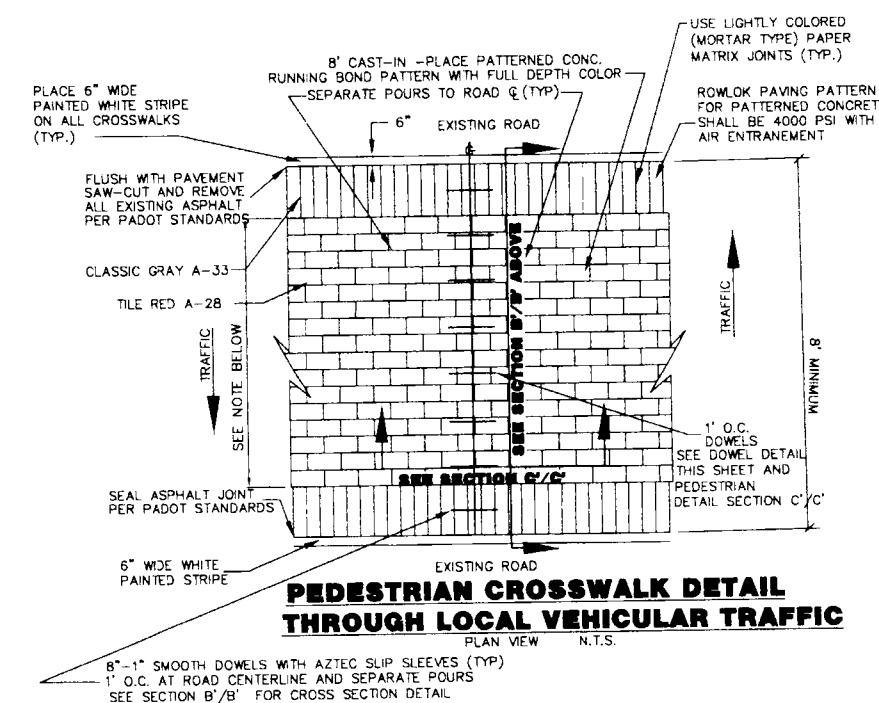

**PEDESTRIAN CROSSWALK DETAIL THROUGH LOCAL VEHICULAR TRAFFIC**  
PLAN VIEW

NOTE:  
ADJUST PATTERNED CONCRETE WIDTH IF NECESSARY TO PROVIDE FULL WIDTH BRICK PATTERN.

- TOPSOIL MIXTURE: TOP GRADE TOPSOIL USE 1 PART PEAT MOSS TO 5 PARTS TOPSOIL (TYP) FOR AREA 5' X 5' AREA AROUND THE TREE (TYP). TOPSOIL SHALL BE LIGHTLY COMPACTED.
- COMPACTED TOPSOIL

**CURB CUT RAMPS FOR THE PHYSICALLY HANDICAPPED NOTES**

1. THE SLOPES OF THE WHEELCHAIR RAMP SHALL BE A MAXIMUM OF 12 TO 1 (12" HORIZONTAL TO 1" VERTICAL). HOWEVER, IF THE 3 FT. LANDING AREA CANNOT BE OBTAINED IN THE NARROW SIDEWALKS WITH THIS SLOPE, IT MAY BE INCREASED, BUT IN NO CASE SHOULD IT EXCEED A MAXIMUM OF 8 TO 1 (8" HORIZONTAL TO 1" VERTICAL).
2. RAMP SURFACE SHALL BE ROUGHER TEXTURED SURFACE THAN USED ON THE SURROUNDING SIDEWALK. USE TRUNCATED DOME CONSTRUCTION PAVERS FOR DETECTABLE WARNINGS. SEE RC-87M FOR ADDITIONAL DETAILS.
3. PEDESTRIAN SIGNS, IN ACCORDANCE TO ADA SPECIFICATIONS SHALL BE PROVIDED FOR BUS ROUTE IDENTIFICATION, INFORMATIONAL SIGNAGE AND WARNING SIGNS. SEE SPECIFICATIONS IDENTIFIED IN ADAAG 703.5.
4. THE DETECTABLE WARNING PAVERS SHALL BE 2' WIDE THE ENTIRE LENGTH OF THE DEPRESSED ACCESSIBLE RAMP (TYPICALLY 4' WIDE MIN) ALONG THE EDGE OF THE FLUSH CONCRETE CURB.
5. DETECTABLE WARNINGS, A DISTINCTIVE SURFACE PATTERN OF DOMES DETECTABLE BY A CANE OR UNDERFOOT, ARE REQUIRED ON THE SURFACE OF CURB RAMPS.
6. FOLLOW ALL CURRENT ADA GUIDELINES FOR REQUIRED TACTILE SURFACING FOR ALL ACCESSIBLE RAMPS AS INDICATED ON THE SITE PLAN. TACTILE WARNING STRIPS SHALL BE INSTALLED ON ALL RAMPS AS SHOWN ON THE PLANS DESIGNATED BY (R).

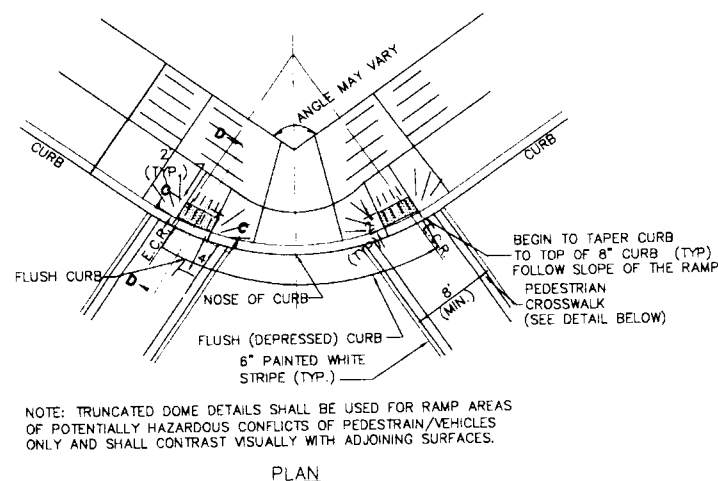

**CURB CUT RAMPS FOR THE PHYSICALLY HANDICAPPED**  
N.T.S.

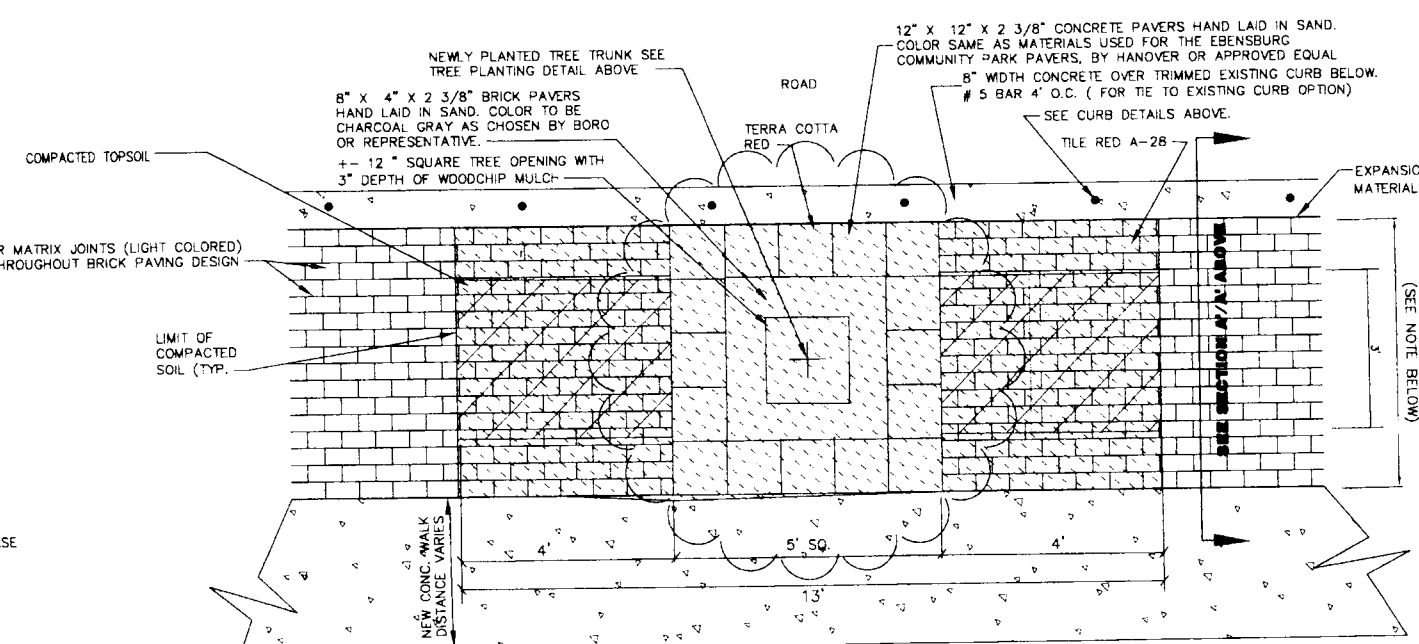
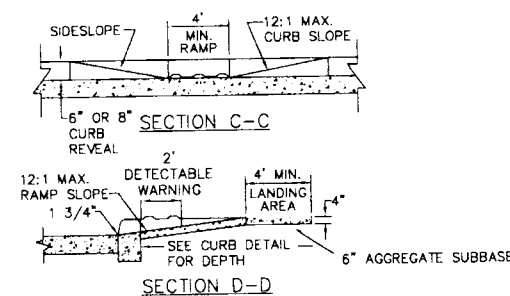

**PLAN VIEW TREE INSTALLATION DETAIL WITHIN SIDEWALK**  
N.T.S.

NOTE:  
ADJUST PATTERNED CONCRETE WIDTH IF NECESSARY TO PROVIDE FULL WIDTH BRICK PATTERN.



CONSULTANT'S

**EBENSBURG  
 MAIN  
 STREET  
 DEVELOPMENT**  
 EBENSBURG BOROUGH  
 CAMBRIA COUNTY, PA

PROJECT NAME

EBENSBURG, PA.

OWNER

REV	DATE	DESCRIPTION
△	09/21/04	RE-BID
ISSUE		03/08/04
PROJECT NO		03-1300-0377
SCALE		NOT TO SCALE
DRAWN BY		NLS
CHECKED BY		GLH

L. Robert Kimball & Associates

SHEET TITLE

**SITE  
 DETAILS**

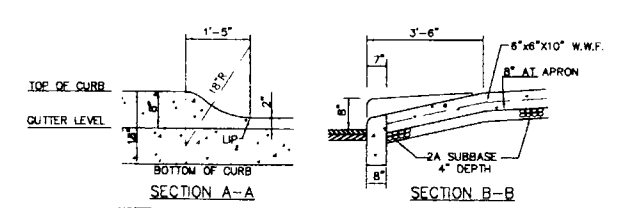

- NOTES:
- 1/2" PREMOULDED EXPANSION JOINTS EVERY 30' OR LESS ON CURB AND SIDEWALK.
  - SCORE SIDEWALK EVERY 5 LINEAL FEET AND CURB EVERY 10 FEET.
  - CONCRETE STRENGTH-4000 P.S.I.
  - 4 INCHES OF PADOT 2A COARSE AGGREGATE TO BE USED AS BASE MATERIAL FOR ALL CURBS & SIDEWALKS.

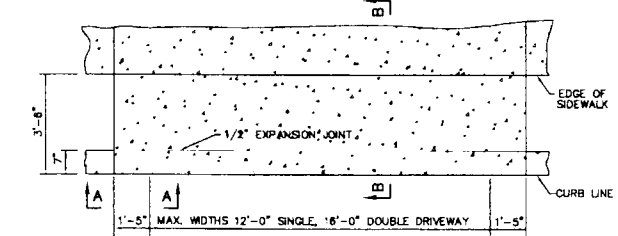

**DEPRESSED CURB DRIVE ENTRANCE PLAN**  
 N.T.S.

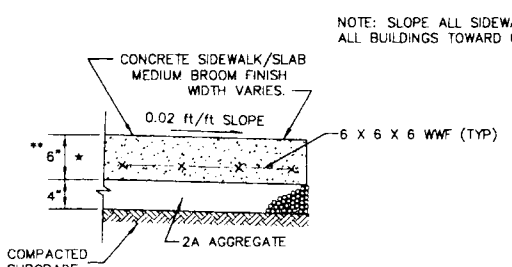

**SIDEWALK/SLAB DETAIL**  
 N.T.S.

- \* USE TYPE 'A' CONCRETE
- \*\* USE 8" OF CONCRETE THICKNESS FOR AREAS WHERE ALL DRIVEWAY ENTRANCES OCCUR AND HEAVY DUTY CONCRETE IS SPECIFIED.

NOTE: SLOPE ALL SIDEWALKS MINIMUM 1% AWAY FROM ALL BUILDINGS TOWARD CURBS.

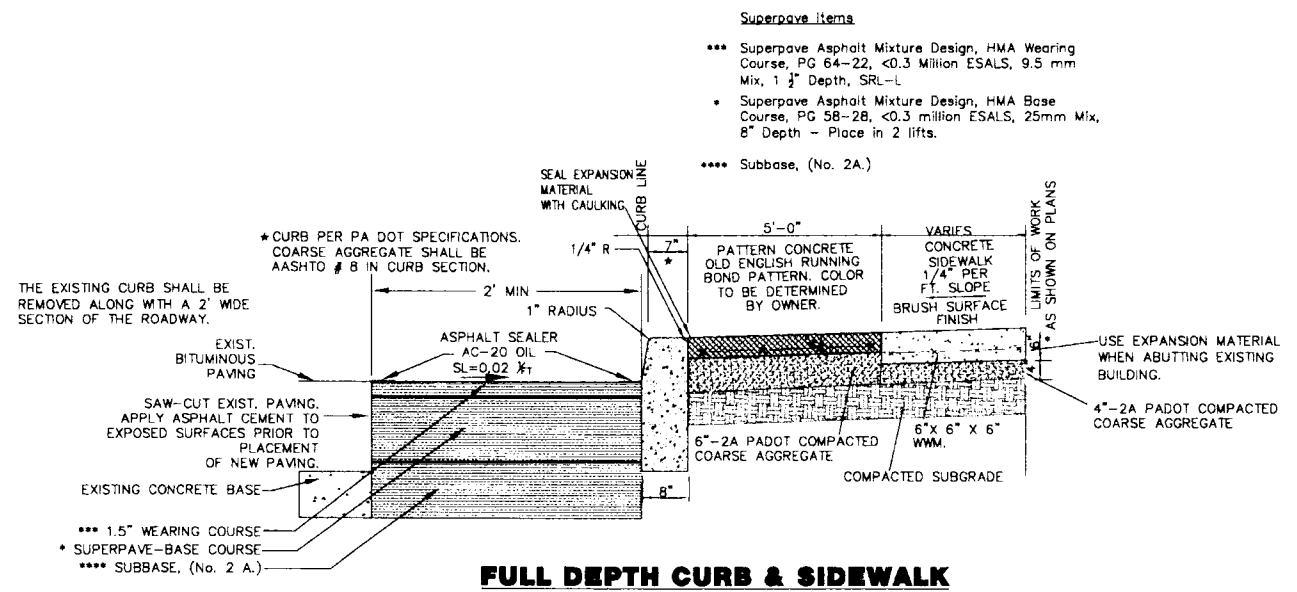

**FULL DEPTH CURB & SIDEWALK  
 SECTION A/A  
 (EAST HIGH STREET)**  
 N.T.S.

- \* USE TYPE 'A' CONCRETE
- NOTES:
- 1 ALL CONCRETE FOR CURB CONSTRUCTION SHALL BE CONSOLIDATED WITH A VIBRATOR (INTERNAL) IN ACCORDANCE WITH ACI 309, TABLE 5.1.4.
  - 2 APPLY HOT BITUMINOUS MIXTURE WHERE CURBING ABUTS STREET PAVEMENT TO SEAL JOINT.
  - 3 REPAIR ALL STREET PAVEMENT DAMAGED BY CURB REMOVAL AND REPLACEMENT OPERATIONS PER PA DOT STANDARDS.
  - 4 SAW CUTTING AND EXCAVATION IS INCIDENTAL TO CURB INSTALLATION COST.
  - 5 THE REMOVAL OF THE EXISTING SIDEWALK IS INCIDENTAL TO THE COST TO INSTALL NEW SIDEWALK.

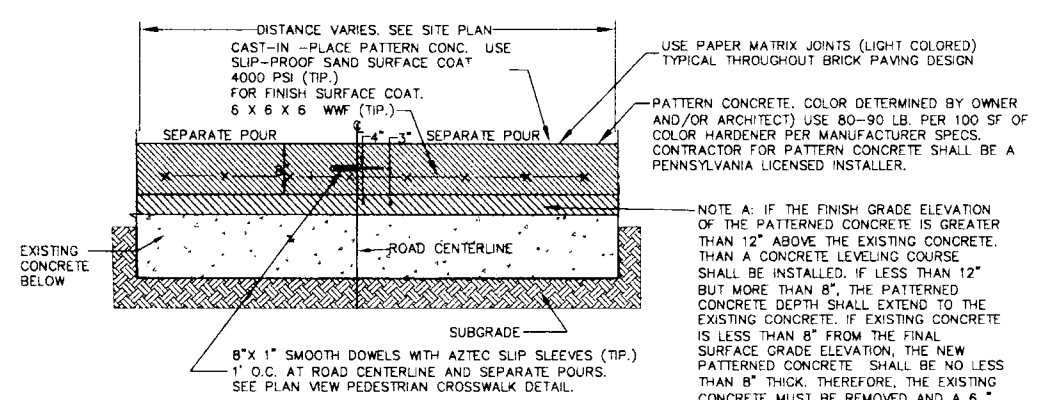

**PEDESTRIAN CROSSWALK CENTERLINE  
 DETAIL CROSS SECTION C/C'**  
 N.T.S.

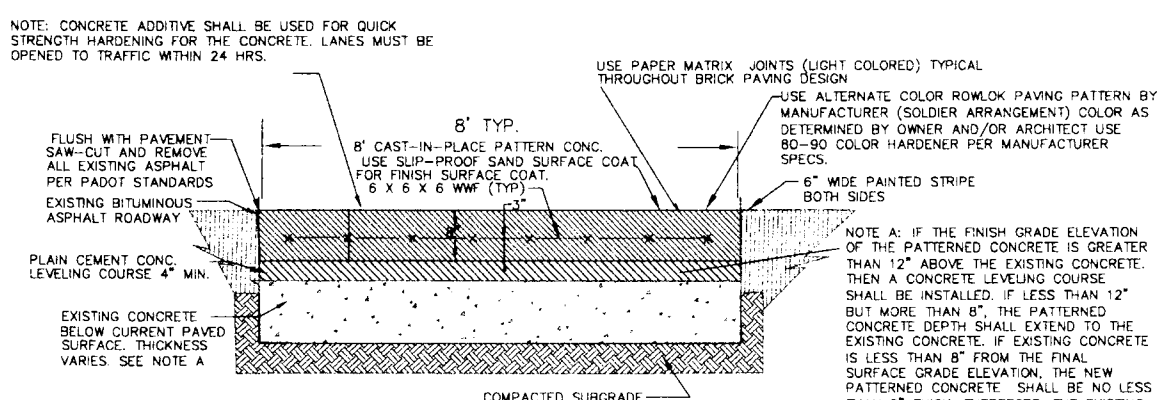

**PEDESTRIAN CROSSWALK PAVEMENT DETAIL  
 THROUGH LOCAL VEHICULAR TRAFFIC  
 SECTION B/B'**  
 N.T.S.

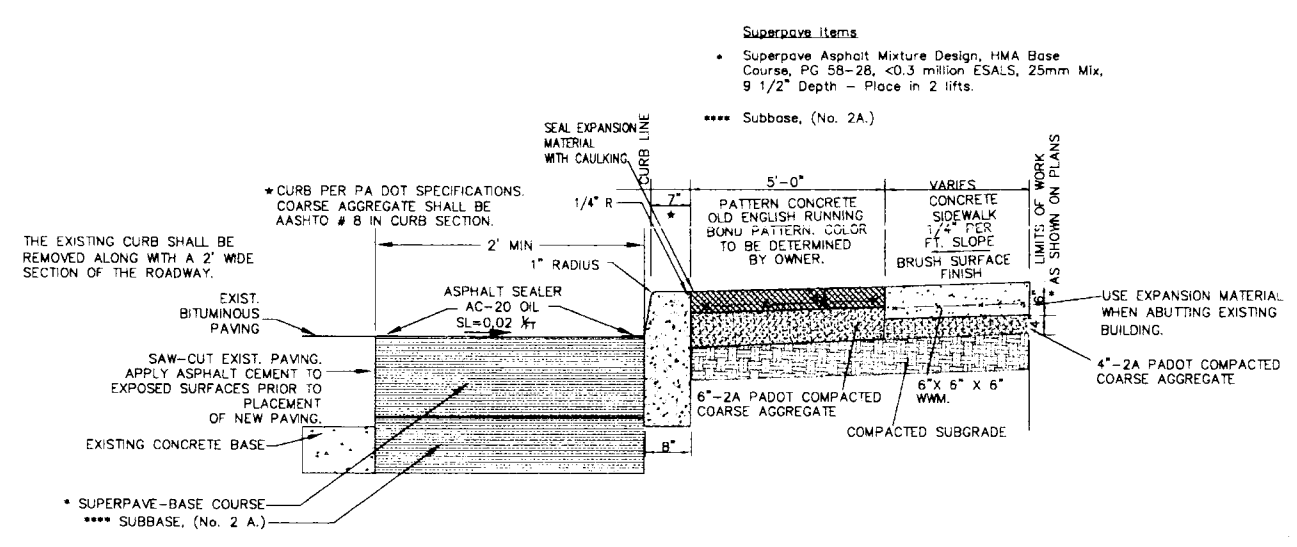

**FULL DEPTH CURB & SIDEWALK  
 SECTION A/A  
 (WEST HIGH STREET, SOUTH CENTER STREET,  
 NORTH CENTER STREET)**  
 N.T.S.

- \* USE TYPE 'A' CONCRETE
- NOTES:
- 1 ALL CONCRETE FOR CURB CONSTRUCTION SHALL BE CONSOLIDATED WITH A VIBRATOR (INTERNAL) IN ACCORDANCE WITH ACI 309, TABLE 5.1.4.
  - 2 APPLY HOT BITUMINOUS MIXTURE WHERE CURBING ABUTS STREET PAVEMENT TO SEAL JOINT.
  - 3 REPAIR ALL STREET PAVEMENT DAMAGED BY CURB REMOVAL AND REPLACEMENT OPERATIONS PER PA DOT STANDARDS.
  - 4 SAW CUTTING AND EXCAVATION IS INCIDENTAL TO CURB INSTALLATION COST.
  - 5 THE REMOVAL OF THE EXISTING SIDEWALK IS INCIDENTAL TO THE COST TO INSTALL NEW SIDEWALK.



**PLANTING SCHEDULE**

PLANTING LEGEND	BOTANICAL NAME	COMMON NAME	SIZE	HEIGHT
○	Prunus coccinea	Cleveland Select	4" to 4 1/2" B & D	Deciduous 15'
○	Prunus coccinea	Redcap	4" to 4 1/2" B & D	Deciduous 35'

LIMIT OF WORK  
S.R. 4031  
STA. 108+74.00  
SEG 0040  
OFFSET 874

**LEGEND**

- STAMPED PATTERNED ASPHALT OR APPROVED EQUAL. BRICK RUNNING BOND STYLE, COLOR TO BE DETERMINED BY BOROUGH.
- NEW CONCRETE SIDEWALKS. (SEE DETAIL) ALL EXISTING CONCRETE, BRICK AND ASPHALT WALKWAYS SHALL BE REMOVED WHERE NEW WALKWAYS ARE SHOWN.
- PATTERNED CONCRETE OF PENNSYLVANIA OR APPROVED EQUAL. STYLE SHALL BE OLD ENGLISH RUNNING BOND. COLOR SHALL BE DETERMINED BY BOROUGH OF EBENSBURG.
- NEW HEAVY DUTY CONCRETE SIDEWALKS. (SEE DETAIL) ALL EXISTING CONCRETE, BRICK AND ASPHALT WALKWAYS SHALL BE REMOVED WHERE NEW WALKWAYS ARE SHOWN.
- LAWN AREA
- EXISTING WATER LINE
- EXISTING GAS LINE
- EXISTING SANITARY SEWER LINE
- ACCESSIBLE RAMP
- DRIVEWAY ENTRANCE
- NOT IN CONTRACT

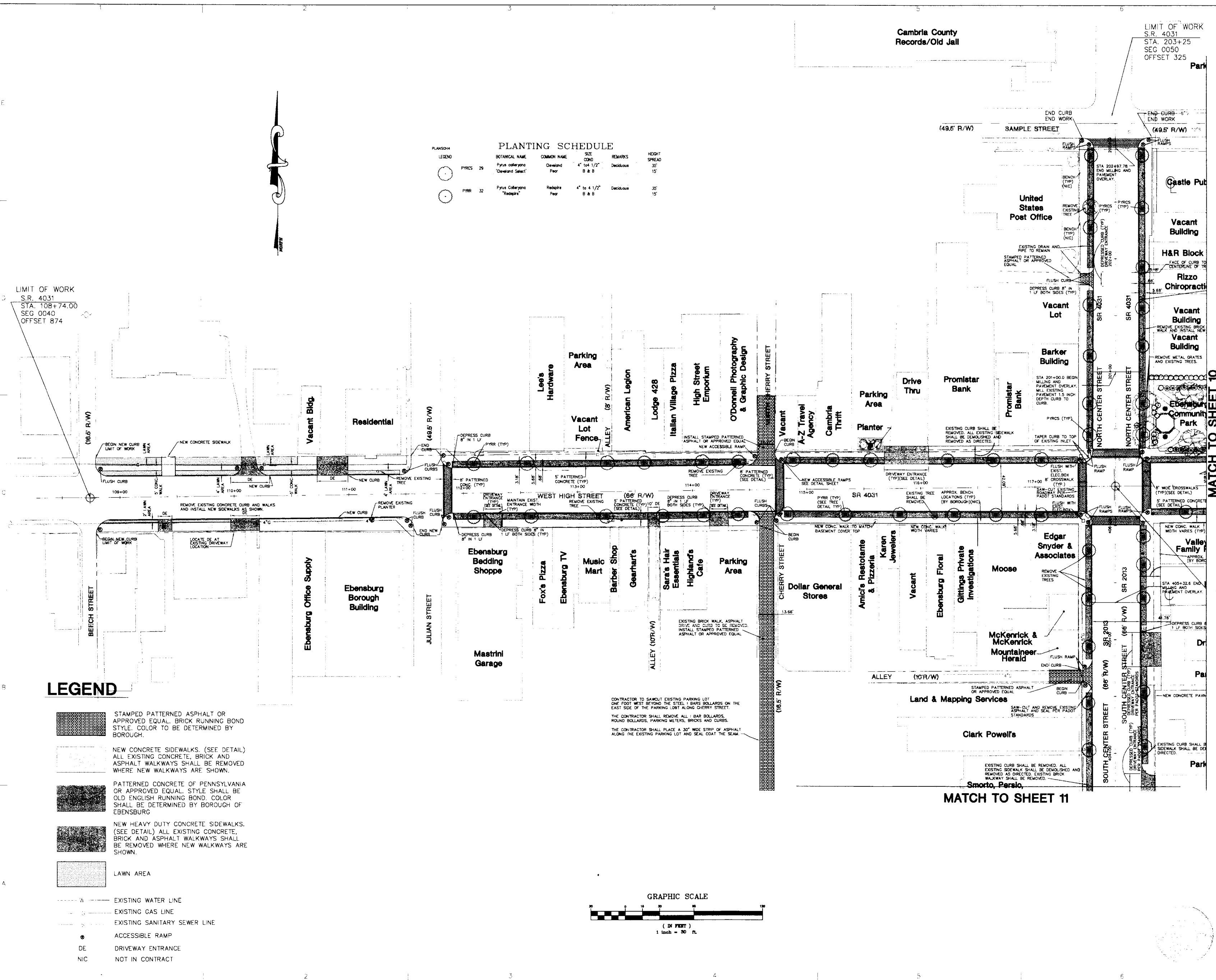
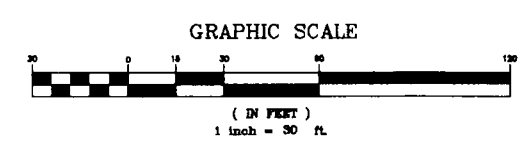

MATCH TO SHEET 11

MATCH TO SHEET 10

CONSULTANTS

EBENSBURG  
MAIN  
STREET  
DEVELOPMENT  
EBENSBURG BOROUGH  
CAMBRIA COUNTY, PA

PROJECT NAME:

EBENSBURG PA

OWNER:

REV	DATE	DESCRIPTION
	09/21/04	RE-BID
ISSUE		03/08/04
PROJECT NO		03-1300-0377
SCALE		1"=30'
DRAWN BY		NLS
CHECKED BY		GLH

© L. Robert Kimball & Associates

SHEET TITLE

**SITE PLAN  
NEW SIDEWALK &  
STREET TREE LAYOUT**

Sheet 10 of 19

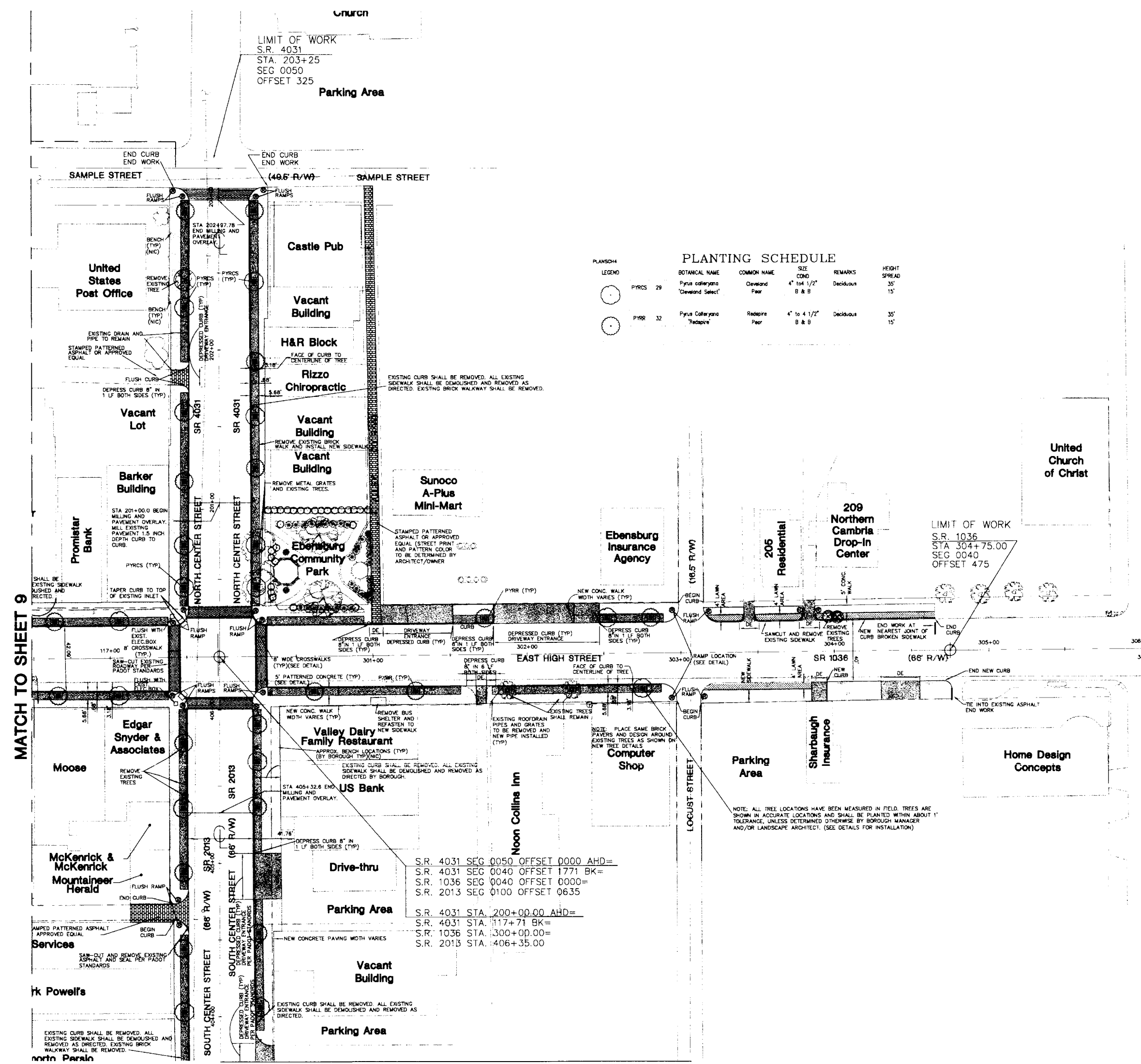

**PLANTING SCHEDULE**

PLANS#	LEGO#	BOTANICAL NAME	COMMON NAME	SIZE	REMARKS	HEIGHT	SPREAD
	29	Pyrus calleryana 'Cleveland Select'	Cleveland Pear	4" to 1 1/2" B & B	Deciduous	35'	15'
	32	Pyrus calleryana 'Pascopae'	Pascopae Pear	4" to 4 1/2" B & B	Deciduous	35'	15'

**LEGEND**

- STAMPED PATTERNED ASPHALT OR APPROVED EQUAL. BRICK RUNNING BOND STYLE. COLOR TO BE DETERMINED BY BOROUGH.
- NEW CONCRETE SIDEWALKS. (SEE DETAIL) ALL EXISTING CONCRETE, BRICK AND ASPHALT WALKWAYS SHALL BE REMOVED WHERE NEW WALKWAYS ARE SHOWN.
- PATTERNED CONCRETE OF PENNSYLVANIA OR APPROVED EQUAL. STYLE SHALL BE OLD ENGLISH RUNNING BOND. COLOR SHALL BE DETERMINED BY BOROUGH OF EBENSBURG.
- NEW HEAVY DUTY CONCRETE SIDEWALKS. (SEE DETAIL) ALL EXISTING CONCRETE, BRICK AND ASPHALT WALKWAYS SHALL BE REMOVED WHERE NEW WALKWAYS ARE SHOWN.
- LAWN AREA
- EXISTING WATER LINE
- EXISTING GAS LINE
- EXISTING SANITARY SEWER LINE
- ACCESSIBLE RAMP
- DRIVEWAY ENTRANCE
- NOT IN CONTRACT

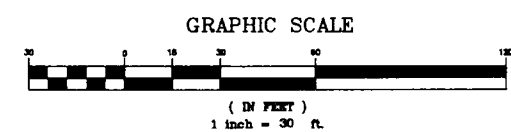

MATCH TO SHEET 11

MATCH TO SHEET 9





CONSULTANTS

**EBENSBURG  
 MAIN  
 STREET  
 DEVELOPMENT**  
 EBENSBURG BOROUGH  
 CAMBRIA COUNTY, PA

PROJECT NAME

EBENSBURG, PA.

OWNER

REV.	DATE	DESCRIPTION
09/21/04	RE-BID	
ISSUE:	03/08/04	
PROJECT NO:	03-1300-0377	
SCALE:	1"=30'	
DRAWN BY:	NLS	
CHECKED BY:	GLH	









© L. Robert Kimball & Associates

SHEET TITLE

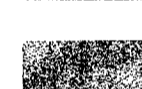
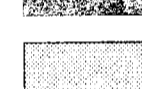

**SITE PLAN  
 NEW SIDEWALK &  
 STREET TREE LAYOUT**

Sheet 11 of 19

**LEGEND**

-  STAMPED PATTERNED ASPHALT OR APPROVED EQUAL. BRICK RUNNING BOND STYLE. COLOR TO BE DETERMINED BY BOROUGH.
-  NEW CONCRETE SIDEWALKS. (SEE DETAIL) ALL EXISTING CONCRETE, BRICK AND ASPHALT WALKWAYS SHALL BE REMOVED WHERE NEW WALKWAYS ARE SHOWN.
-  PATTERNED CONCRETE OF PENNSYLVANIA OR APPROVED EQUAL. STYLE SHALL BE OLD ENGLISH RUNNING BOND. COLOR SHALL BE DETERMINED BY BOROUGH OF EBENSBURG.
-  NEW HEAVY DUTY CONCRETE SIDEWALKS. (SEE DETAIL) ALL EXISTING CONCRETE, BRICK AND ASPHALT WALKWAYS SHALL BE REMOVED WHERE NEW WALKWAYS ARE SHOWN.
-  LAWN AREA
-  EXISTING WATER LINE
-  EXISTING GAS LINE
-  EXISTING SANITARY SEWER LINE
-  ACCESSIBLE RAMP
-  DRIVEWAY ENTRANCE
-  NOT IN CONTRACT

**PLANTING SCHEDULE**

PLANS/04	LEGEND	BOTANICAL NAME	COMMON NAME	SIZE COND	REMARKS	HEIGHT	SPREAD
		Pyrus calleryana "Cleveland Select"	Cleveland Pear	4" to 4 1/2" B & D	Deciduous	35'	15'
		Pyrus calleryana "Tussock"	Tussock Pear	4" to 4 1/2" B & B	Deciduous	35'	15'

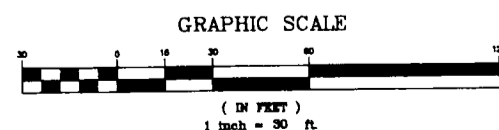

MATCH TO SHEET 9

MATCH TO SHEET 10

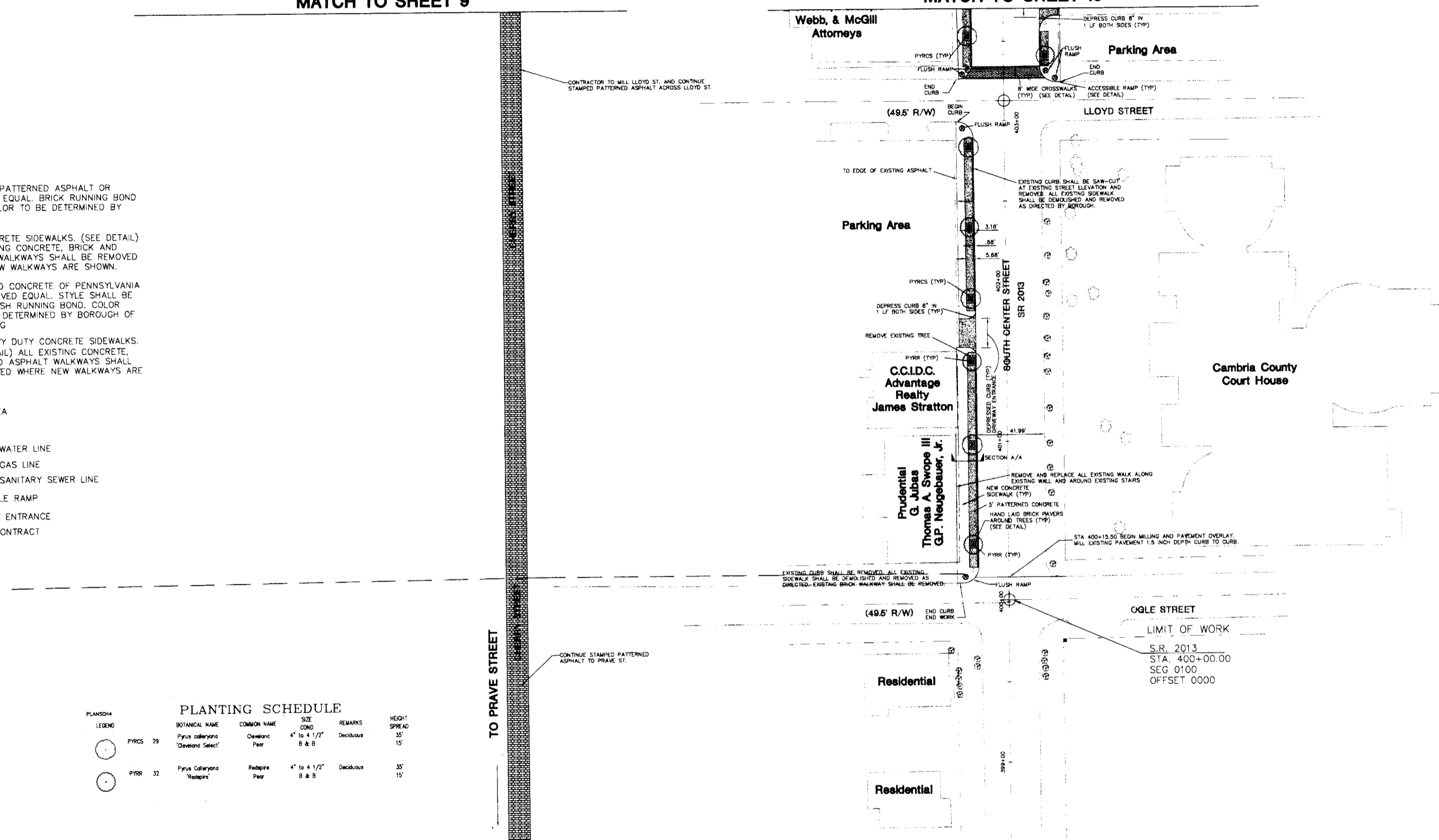

CONTRACTOR TO MILL LLOYD ST. AND CONTINUE STAMPED PATTERNED ASPHALT ACROSS LLOYD ST.

CONTINUE STAMPED PATTERNED ASPHALT TO PRAVE ST.

LIMIT OF WORK  
 S.R. 2013  
 STA. 400+00.00  
 SEG 0100  
 OFFSET 0000

TABULATION OF COMPONENT ITEMS  
TRENCH, CONDUIT, JUNCTION BOX, ELECTRICAL ITEMS  
APPROXIMATE QUANTITIES (INFORMATION ONLY)

DESCRIPTION	1 INCH CONDUIT			2 INCH CONDUIT			3 INCH CONDUIT			TRENCH AND BACKFILL, TYPE 1		SIGNAL CABLE, 14 AWG, 3 CONDUCTOR		SIGNAL CABLE, 14 AWG, 5 CONDUCTOR		JUNCTION BOX, JB-27		DETECTOR LEAD IN CABLE	
	LOCATION	ITEM NUMBER	UNIT	LF	LF	LF	LF	LF	LF	LF	LF	LF	LF	LF	LF	LF	LF	LF	
cc - 1				5															
1 - 5				64															
5 - 1		2010	20																
1 - 2							57												
2 - 1							5												
2 - 3							59												
2 - 6			15																
3 - 1							15												
3 - 6							61												
6 - 1		2048	8																
1 - 4							55												
4 - 1							5												
4 - 5							15												
1 S.R. 4031 STA. 117+42 RT																		1	
2 S.R. 4031 STA. 117+40 LT																		1	
3 S.R. 1036 STA. 300+29 LT																		1	
4 S.R. 1036 STA. 300+27 RT																		1	
5 S.R. 4031 STA. 116+78 RT																		1	
6 S.R. 1036 STA. 300+90 LT																		1	
SR 4031 & SR 1036 WIRING INFORMATION												350	725					800	
TOTAL				58	155	171		370				350	725			6		800	

NOTE: SPLICING OF WIRE IS NOT RECOMMENDED FOR PROPER OPERATION OF SIGNALIZED INTERSECTION.

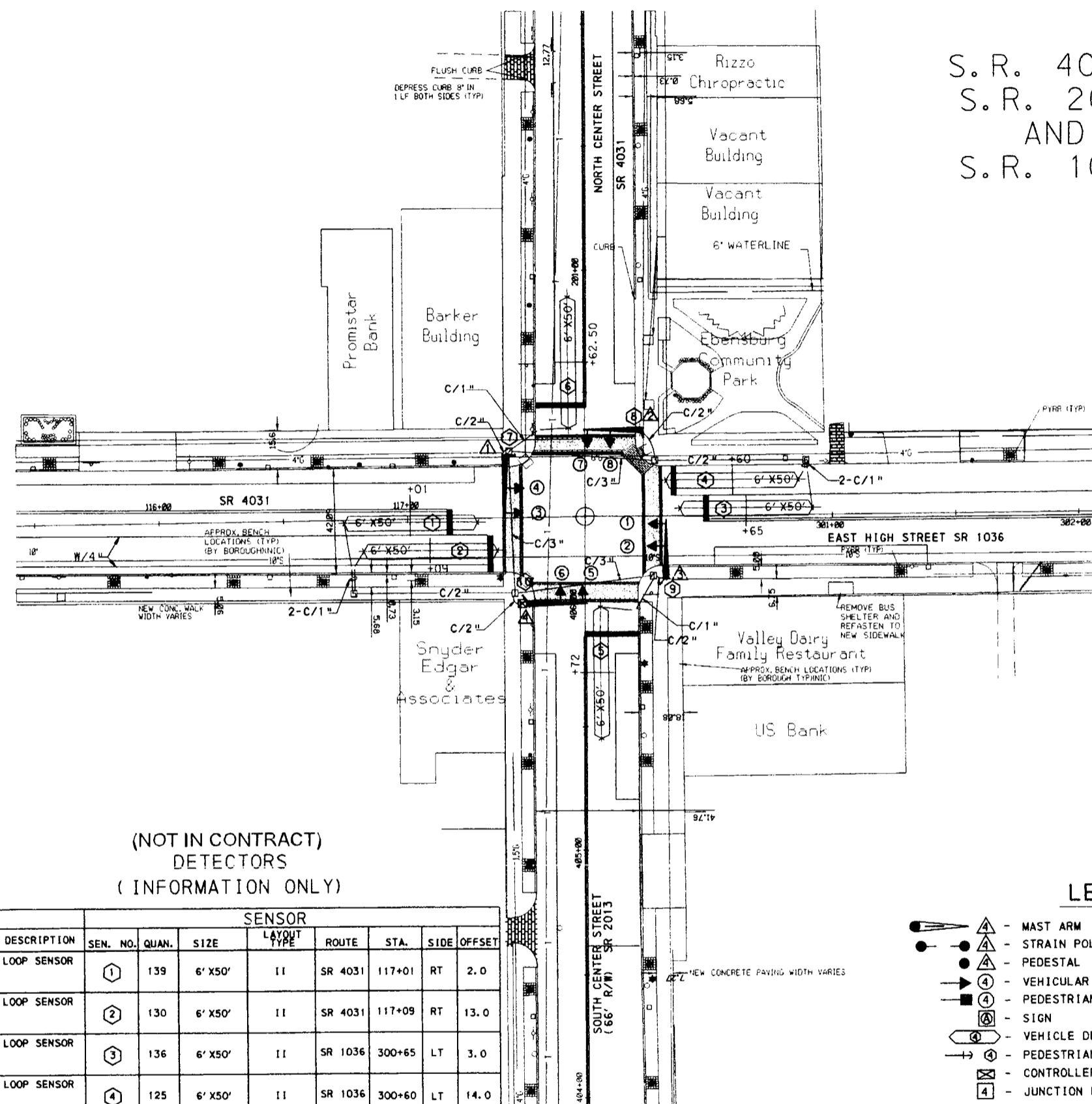

(NOT IN CONTRACT)  
DETECTORS  
(INFORMATION ONLY)

ITEM NUMBER	DESCRIPTION	SENSOR							
		SEN. NO.	QUAN.	SIZE	LAYOUT TYPE	ROUTE	STA.	SIDE	OFFSET
0956 0101	LOOP SENSOR	1	139	6' X 50'	11	SR 4031	117+01	RT	2.0
0956 0101	LOOP SENSOR	2	130	6' X 50'	11	SR 4031	117+09	RT	13.0
0956 0101	LOOP SENSOR	3	136	6' X 50'	11	SR 1036	300+65	LT	3.0
0956 0101	LOOP SENSOR	4	125	6' X 50'	11	SR 1036	300+60	LT	14.0
0956 0101	LOOP SENSOR	5	134	6' X 50'	11	SR 2013	405+72	RT	6.5
0956 0101	LOOP SENSOR	6	133	6' X 50'	11	SR 4031	200+63	LT	7.0

LEGEND

- ▲ - MAST ARM
- ▲— - STRAIN POLE/MESSENGER CABLE
- - PEDESTAL
- ▲ - VEHICULAR SIGNAL HEAD
- ▲ - PEDESTRIAN SIGNAL HEAD
- ▲ - SIGN
- - VEHICLE DETECTOR
- - PEDESTRIAN PUSH BUTTON/SIGN
- - CONTROLLER ASSEMBLY
- - JUNCTION BOX
- C/4" - CONDUIT/SIZE
- W/4" - SOLID WHITE LINE/WIDTH
- BW/4" - BROKEN WHITE LINE/WIDTH
- Y/4" - SOLID YELLOW LINE/WIDTH
- BY/4" - BROKEN YELLOW LINE/WIDTH
- DY/4" - DOUBLE SOLID YELLOW LINE/WIDTH

THIS PLAN HAS BEEN DESIGNED BY PENNDOT AND HAS BEEN INCLUDED FOR INFORMATION ONLY.

EBENSBURG  
MAIN  
STREET  
DEVELOPMENT  
EBENSBURG BOROUGH  
CAMBRIA COUNTY, PA

PROJECT NAME

EBENSBURG, PA

OWNER

REV	DATE	DESCRIPTION
ISSUE	03/08/04	RE-BID
PROJECT NO.	03-1300-0377	
SCALE	NOT TO SCALE	
DRAWN BY	NLS	
CHECKED BY	GLH	

L. Robert Kimball & Associates

SHEET TITLE

SIGNAL CONTROL  
PLAN



**GENERAL MPT NOTES**

- THIS WORK CONSISTS OF MAINTENANCE OF TRAFFIC AND PROTECTION OF THE PUBLIC WHEN APPROACHING AND DEPARTING THE CONSTRUCTION AREA AND WITHIN THE LIMITS OF CONSTRUCTION.
- FURNISH, ERECT, PLACE AND MAINTAIN TRAFFIC CONTROL SIGNS AND DEVICES, MAINTAIN TRAFFIC DURING HOURS OF CONSTRUCTION AND AT ALL OTHER TIMES IN ACCORDANCE WITH THE METHODS INDICATED ON THESE DRAWINGS AND THE FOLLOWING:
  - THE SPECIAL PROVISIONS OF THE CONTRACT.
  - PA CODE, TITLE 67, CHAPTER 203, WORK ZONE TRAFFIC CONTROLS.
  - PA CODE TITLE 67, CHAPTER 204, GUIDELINES TO IMPLEMENT ACT 229 OF 2002, ADDITIONAL TRAFFIC CONTROL DEVICES IN HIGHWAY WORK ZONES, STATEMENT OF POLICY.
  - PA CODE, TITLE 67, CHAPTER 211, OFFICIAL TRAFFIC CONTROL DEVICES.
  - PENNDOT PUBLICATION NO. 35, APPROVED CONSTRUCTION MATERIALS (BULLETIN 15).
  - PENNDOT PUBLICATION NO. 408/2003, SPECIFICATIONS.

- REMOVE THESE DEVICES IMMEDIATELY UPON COMPLETION OF THE WORK. THE DEPARTMENT WILL REMOVE ANY TRAFFIC CONTROL DEVICES ERECTED BY DEPARTMENT FORCES.
- THE CONTRACTOR MUST ARRANGE FOR INSPECTION OF ALL TRAFFIC CONTROL DEVICES PRIOR TO START OF WORK.
- COVER OR REMOVE ALL CONFLICTING SIGNS AND ERADICATE ALL CONFLICTING PAVEMENT MARKINGS.
- MOUNT ALL LONG TERM ADVANCE WARNING SIGNS ON TYPE III BARRICADES UNLESS OTHERWISE NOTED OR INSTRUCTED BY DISTRICT OFFICE.
- ALL SIGNS AND DEVICES ARE TO BE MAINTAINED IN NEW OR LIKE NEW CONDITIONS.
- DRIVEWAYS WILL BE KEPT ACCESSIBLE AT ALL TIMES. LOCATE ALL SIGNS SO THAT THE SIGHT DISTANCE WILL NOT BE OBSTRUCTED AT DRIVEWAYS AND SIDE STREETS.
- ALL LONG TERM WARNING SIGNS SHALL BE TYPE III FLUORESCENT ORANGE OR TYPE VII REFLECTORIZED SHEETING.
- THE CONTRACTOR SHALL NOTIFY LOCAL EMERGENCY AUTHORITIES (POLICE, FIRE, MEDICAL, ETC.), AFFECTED BUSINESSES, SCHOOL DISTRICT(S), THE GENERAL PUBLIC AND THE DISTRICT COMMUNITY RELATIONS COORDINATOR AT LEAST FOURTEEN DAYS PRIOR TO ANY SIGNIFICANT TRAFFIC IMPACTS (e.g., LONG TERM LANE RESTRICTIONS, DETOURS).
- DETOURS OF STATE ROUTES SHALL NOT BE PERMITTED. DETOURS OF LOCAL HIGHWAYS SHALL HAVE THE PRIOR APPROVAL OF THE APPROPRIATE LOCAL AUTHORITIES.
- IN ADDITION TO THE LONG-TERM SIGNING SHOWN (DETAIL A), PROVIDE SHORT-TERM SIGNING IN ACCORDANCE WITH PENNDOT PUBLICATION 203, WORK ZONE TRAFFIC CONTROL, FIGURES 5, 7, 10A AND 10b.
- SEE SPECIAL PROVISIONS FOR ADDITIONAL REQUIREMENTS AND RESTRICTIONS.

**FLAGGING NOTES**

- IN ADDITION TO THE ABOVE REQUIREMENTS, COMPLY WITH THE FOLLOWING:
- ALL DISTANCES MAY BE ADJUSTED SLIGHTLY TO FIT FIELD CONDITIONS.
  - A MINIMUM OF SIX CHANNELIZING DEVICES SHALL BE USED FOR EACH TAPER.
  - ALL FLAGGERS SHALL BE IN COMMUNICATION WITH EACH OTHER.
  - IN ADDITION TO THE FLAGGERS SHOWN, PROVIDE A FLAGGER FOR ANY BUSINESS DRIVEWAYS WITHIN THE ONE-LANE, TWO-WAY TRAFFIC AREA.
  - PARALLEL PARKING IN THE WORK AREA SHALL BE RESTRICTED AS FOLLOWS:
    - ELIMINATE ALL PARKING ADJACENT TO THE CLOSED LANE.
    - MAINTAIN THE PARKING ADJACENT TO THE OPEN LANE EXCEPT IN THE AREA ADJACENT TO THE CROSSWALK.
    - COVER THE PARKING METERS AND PLACE "NO PARKING" SIGNS THROUGHOUT THE RESTRICTED PARKING AREAS.
  - AT ROAD CLOSURE LOCATIONS PLACE SUFFICIENT TYPE III BARRICADES TO COMPLETELY CLOSE THE ROADWAY.
  - WHEN A SIGNALIZED INTERSECTION IS BEING FLAGGED, THE SIGNAL SHALL BE PLACED ON THE FLASHING MODE OF OPERATION.
  - DURING HOURS OF DARKNESS, EACH FLAGGER STATION SHALL BE ILLUMINATED WITH FLOODLIGHTS.
  - DURING HOURS OF DARKNESS, ALL CHANNELING DEVICES SHALL BE REFLECTORIZED AND EACH CHANNELIZING DEVICE IN A TAPER SHALL HAVE A TYPE C LIGHT.
  - SEE SPECIFIC PHASE DETAILS FOR SIGNING, DEVICE AND FLAGGER REQUIREMENTS AND PLACEMENT.
  - THE CONTRACTOR SHALL COMPLETE THE CROSSWALK WORK IN SUCCESSFUL ORDER.
  - SEE SPECIAL PROVISIONS FOR ADDITIONAL REQUIREMENTS AND RESTRICTIONS.

**SYMBOLS**

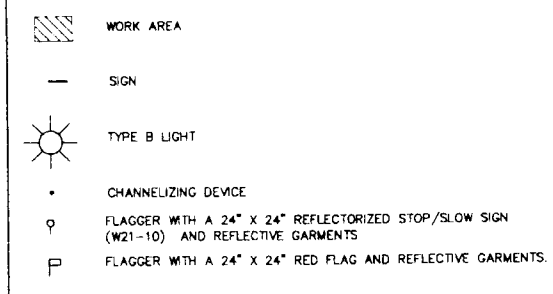

**TABULATION OF TRAFFIC CONTROL DEVICES (FOR INFORMATION ONLY - INCLUDED IN ITEM #0901-0001)**

STD. NO.	SIZE	DESCRIPTION	TOTAL REQUIRED
WB-1	30"x30"	BUMP	*
W13-1	24"x24"	ADVISORY SPEED	12
W21-4	36"x36"	ROAD WORK SIGN	12
W30-1-1		DISTANCE PANEL (500 FT)	4
W30-1-2		DISTANCE PANEL (1000 FT)	4
W30-1-3		DISTANCE PANEL (1500 FT)	4
Q20-2A	60"x24"	END ROAD WORK	4
R11-2	60"x30"	ROAD CLOSED SIGN	6
R9-B	24"x12"	PEDESTRIAN CROSS WALK **	*
R9-9	24"x12"	SIDEWALK CLOSED **	*
R9-10	24"x12"	SIDEWALK CLOSED USE OTHER SIDE **	*
R9-11	24"x12"	SIDEWALK CLOSED AHEAD CROSS HERE **	*
R9-11A	24"x12"	SIDEWALK CLOSED CROSS HERE **	*
W11-2	30"x30"	PEDESTRIAN CROSSING **	*
W16-7P	24"x12"	DIAGONAL ARROW **	*
RB-3A	24"x24"	NO PARKING	*
		TYPE III BARRICADES	*
		CHANNELIZING DEVICES	*
		TYPE B LIGHTS	*
		TYPE C LIGHTS	*

\* PROVIDE SUFFICIENT QUANTITY  
 \*\* SEE "PEDESTRIAN TRAFFIC CONTROL" THIS SHEET

**TABULATION OF TRAFFIC CONTROL DEVICES SEPARATE PAY ITEMS**

ITEM NO.	QUANTITY	DESCRIPTION
0901-0240	100 SF	ADDITIONAL TRAFFIC CONTROL SIGNS
0901-0202	2 EA	FLOODLIGHTS

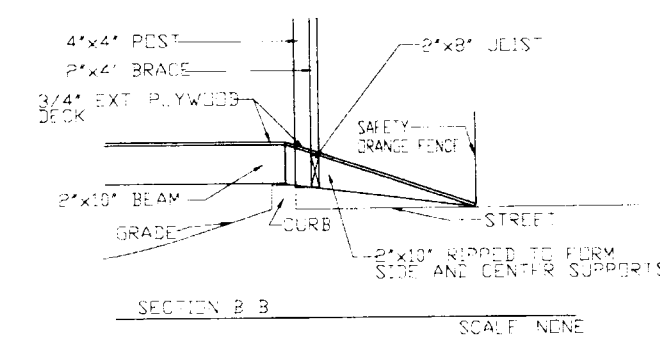
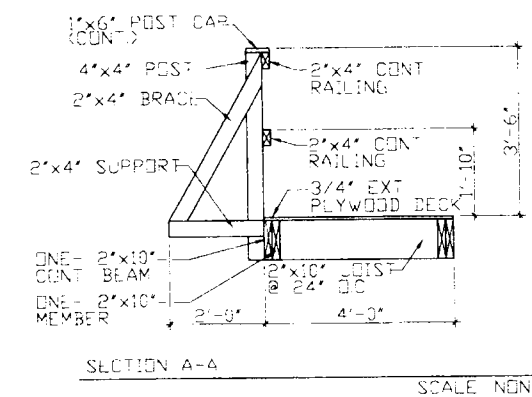

2"x10" RIPPED SUPPORTS FOR SIDE AND CENTER BEAMS SEE SECTION B-B

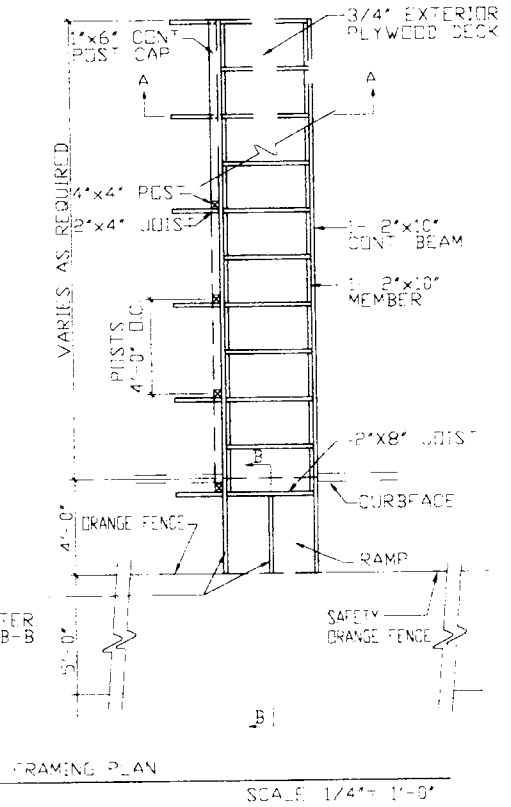

NOTES  
 1) RAMP AT BUILDING ENTRANCE MUST BE ADJUSTED TO ACCOMMODATE VARYING ENTRANCE CONDITIONS

**PEDESTRIAN TEMPORARY WALKWAYS**

NOTES  
 PEDESTRIAN TEMPORARY WALKWAYS TO BE PROVIDED AT EVERY BUILDING AND RESIDENCE WITHIN THE PORTION OF THE SITE UNDER CONSTRUCTION

**PEDESTRIAN TRAFFIC CONTROL**

AT EXISTING SIDEWALK OR CROSSWALK LOCATIONS WHERE PEDESTRIAN TRAFFIC CAN NOT BE MAINTAINED, PROVIDE PEDESTRIAN TRAFFIC CONTROL IN ACCORDANCE WITH THE MANUAL ON UNIFORM TRAFFIC CONTROL DEVICES, 2003 EDITION, FIGURES 6H-28 AND 6H-29 (SEE CONTRACT ATTACHMENT "MAINTENANCE AND PROTECTION OF PEDESTRIAN TRAFFIC", SHEETS 1-4 OF 4) AND IN ACCORDANCE WITH THE CONTRACT SPECIAL PROVISIONS.

615 West Highland Ave.  
 Ebensburg, Pa. 15931  
 phone (814) 472-7700  
 fax (814) 472-7712  
 email laarde@kimball.com  
 web site www.lrkimball.com

CONSULTANTS

**EBENSBURG MAIN STREET DEVELOPMENT**  
 EBENSBURG BOROUGH  
 CAMBRIA COUNTY, PA

PROJECT NAME

EBENSBURG, PA.

OWNER

REV.	DATE	DESCRIPTION
09/21/04	RE-BID	
	03/08/04	ISSUE
	03-1300-0377	PROJECT NO
	NOT TO SCALE	SCALE
	NLS	DRAWN BY
	GLH	CHECKED BY

© L. Robert Kimball & Associates

SHEET TITLE

**TRAFFIC CONTROL PLAN**

RECOMMENDED 12-18-2004  
*John P. Antonini*  
 DISTRICT TRAFFIC ENGINEER

*Conrad Mohr*  
 12-19-04

CONSULTANTS

EBENSBURG  
MAIN  
STREET  
DEVELOPMENT  
EBENSBURG BOROUGH  
CAMBRIA COUNTY, PA

PROJECT NAME

EBENSBURG, PA.

OWNER

REV	DATE	DESCRIPTION
	09/21/04	RE-BID
ISSUE		03/08/04
PROJECT NO		03-1300-0377
SCALE		NOT TO SCALE
DRAWN BY		NLS
CHECKED BY		GLH

© L. Robert Kimball & Associates

SHEET TITLE

**TRAFFIC CONTROL PLAN**

Sheet 14 of 19

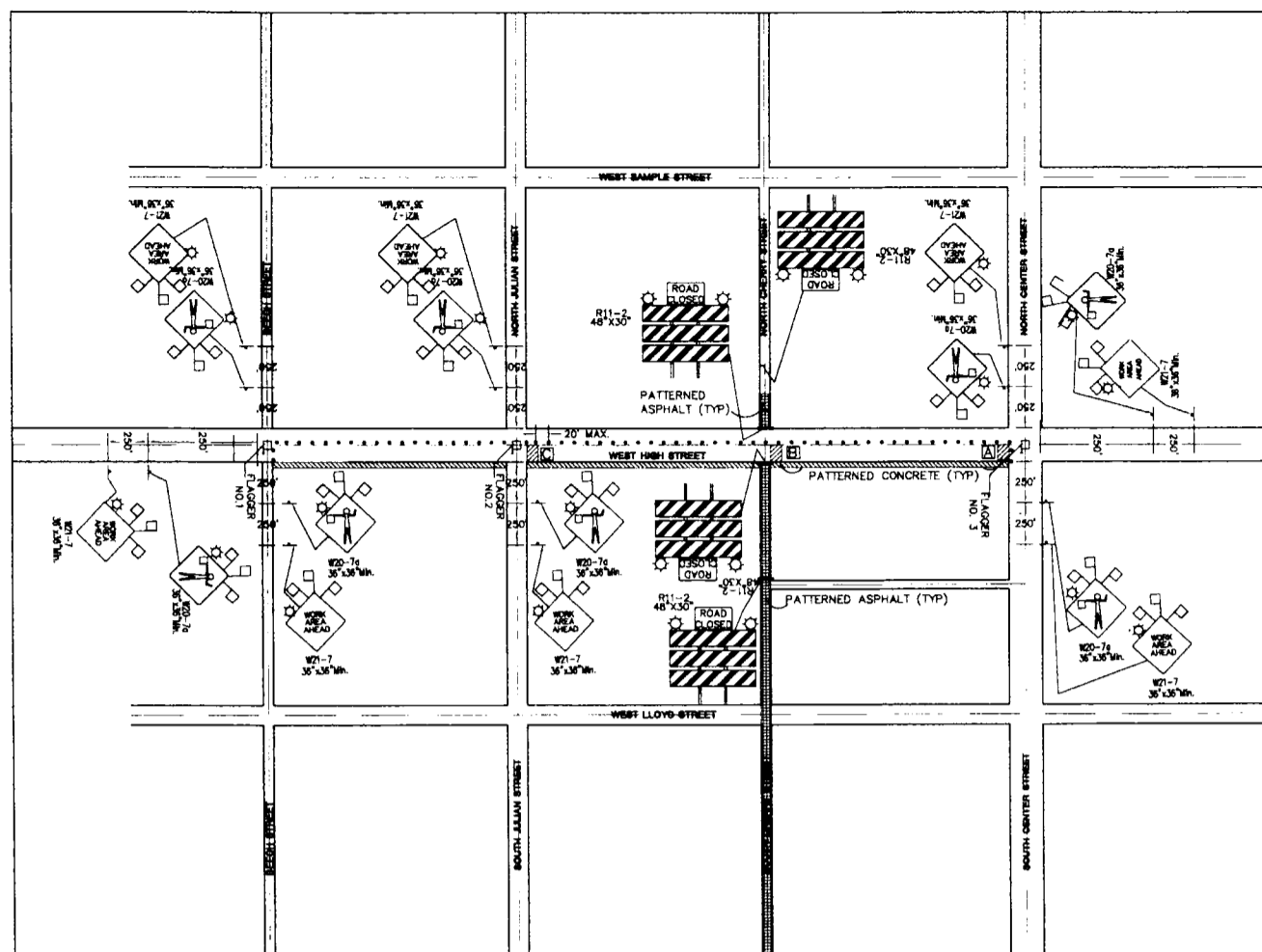

PHASE 1

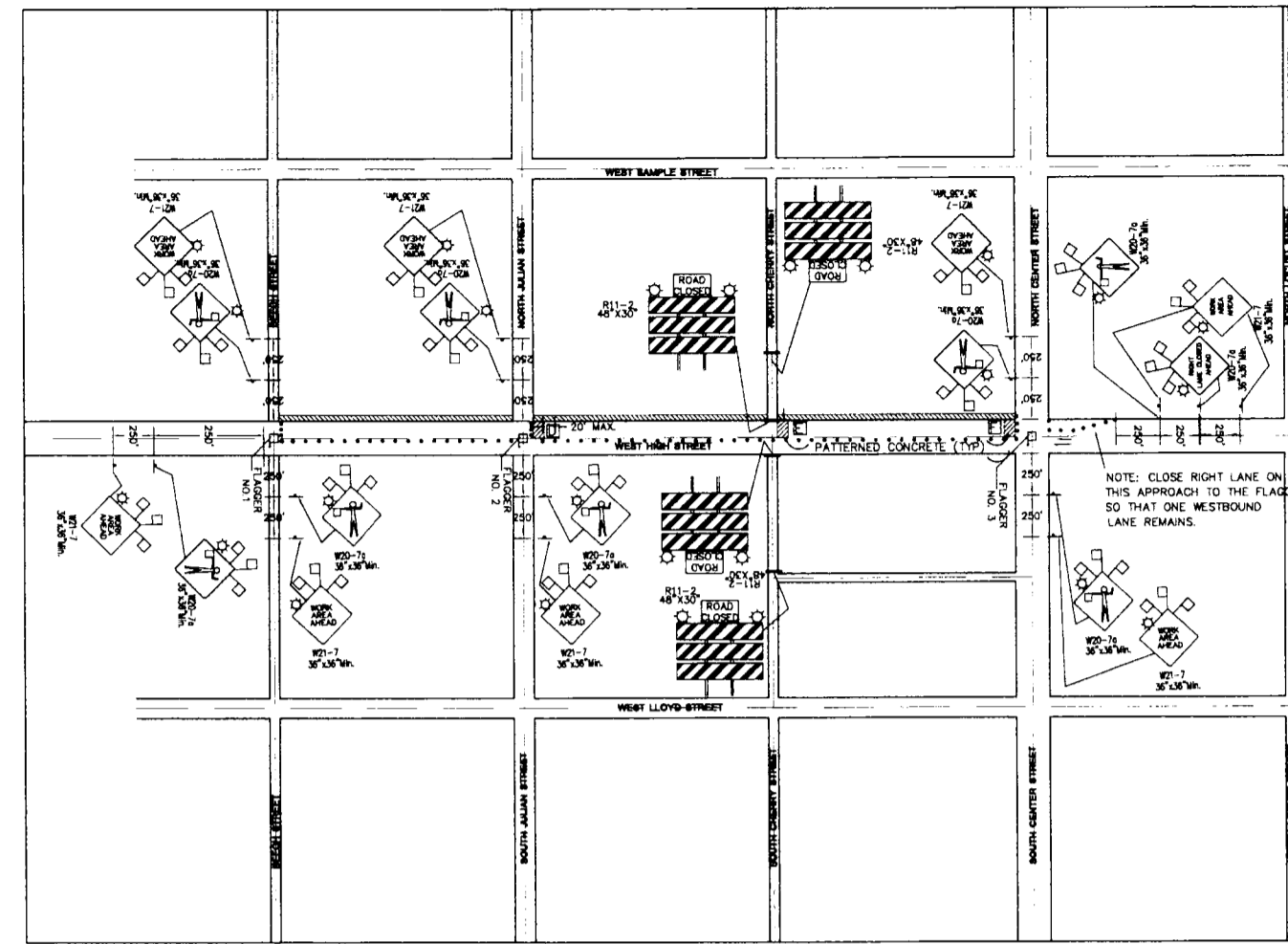

PHASE 2

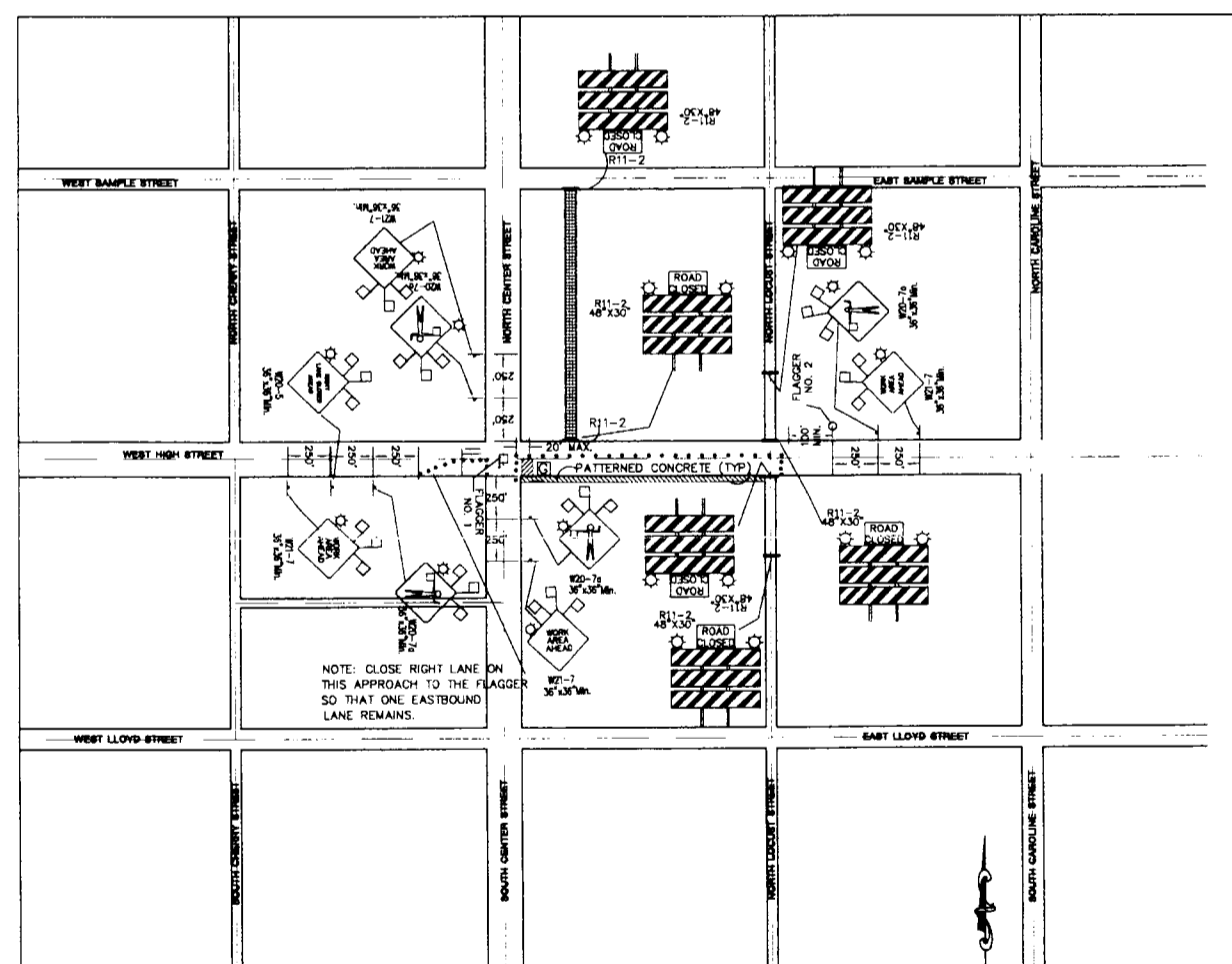

PHASE 3

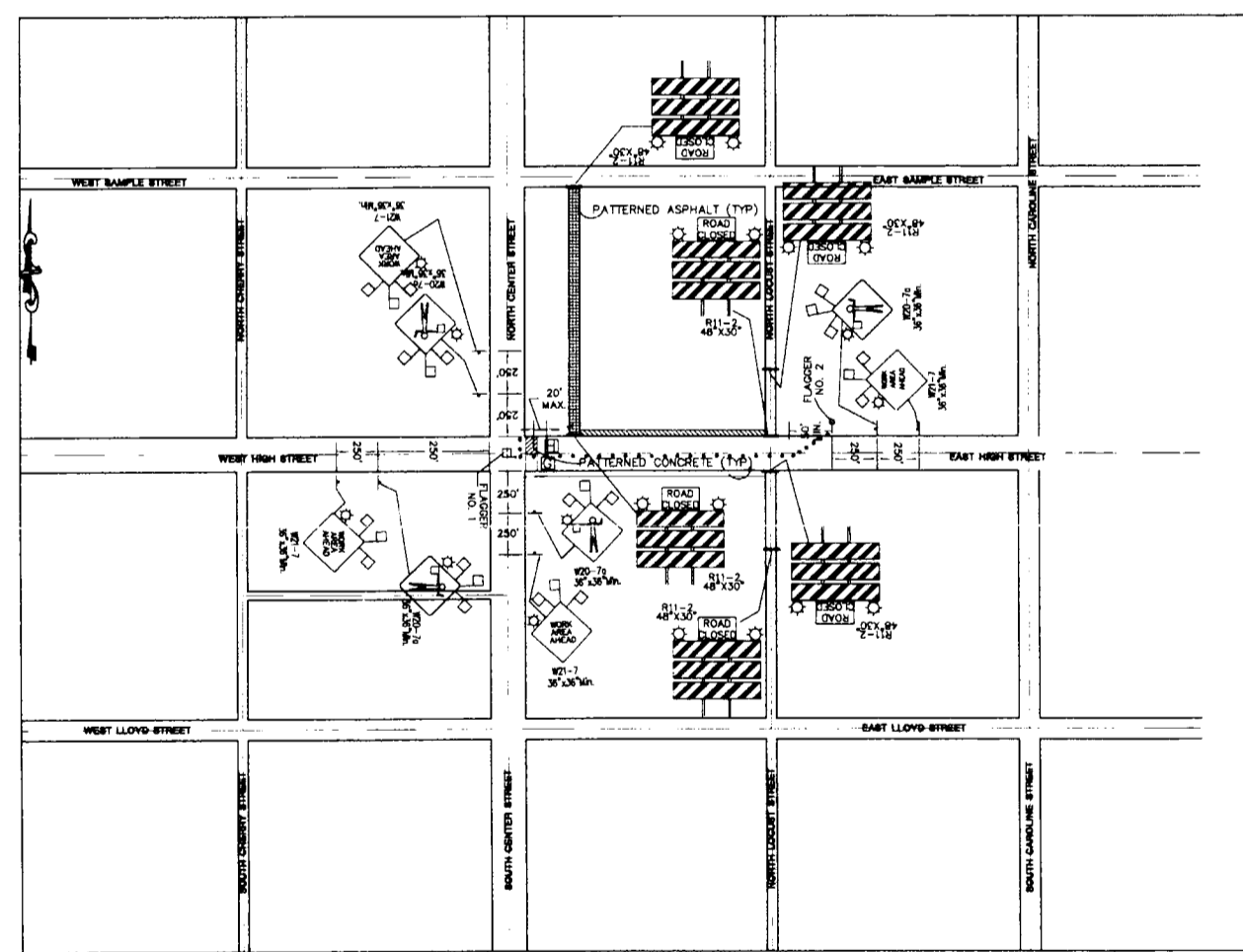

PHASE 4

**SYMBOLS**

- WORK AREA
- SIGN
- TYPE B LIGHT
- CHANNELIZING DEVICE
- FLAGGER WITH A 24" X 24" REFLECTORIZED STOP/SLOW SIGN (W21-10) AND REFLECTIVE GARMENTS
- FLAGGER WITH A 24" X 24" RED FLAG AND REFLECTIVE GARMENTS

NOTE: MINIMIZE PHYSICAL LENGTH OF ANY TRAVEL LANE CLOSURES. CLOSE ONLY THOSE PORTIONS OF TRAVEL LANES WHERE WORK IS IN ACTIVE PROGRESS

*Robert Kimball*  
12.11.04



CONSULTANTS

**EBENSBURG  
MAIN  
STREET  
DEVELOPMENT**  
EBENSBURG BOROUGH  
CAMBRIA COUNTY, PA

PROJECT NAME

EBENSBURG, PA.

OWNER

REV.	DATE	DESCRIPTION
09/21/04	RE-BID	
03/08/04	ISSUE	
03-1300-0377	PROJECT NO.	
NOT TO SCALE	SCALE	
NLS	DRAWN BY	
GLH	CHECKED BY	

L. Robert Kimball & Associates

SHEET TITLE

**TRAFFIC CONTROL  
PLAN**

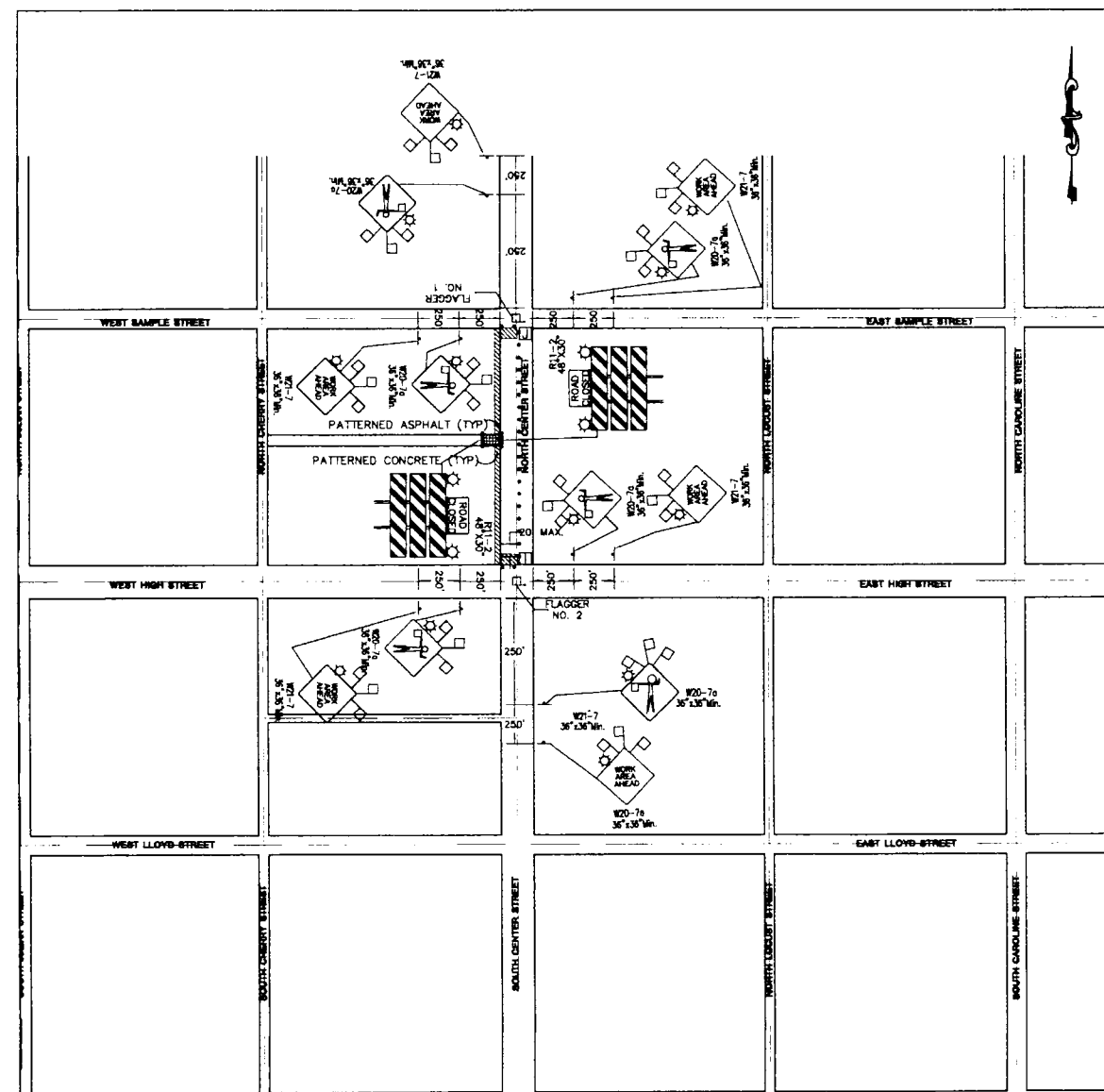

**PHASE 5**

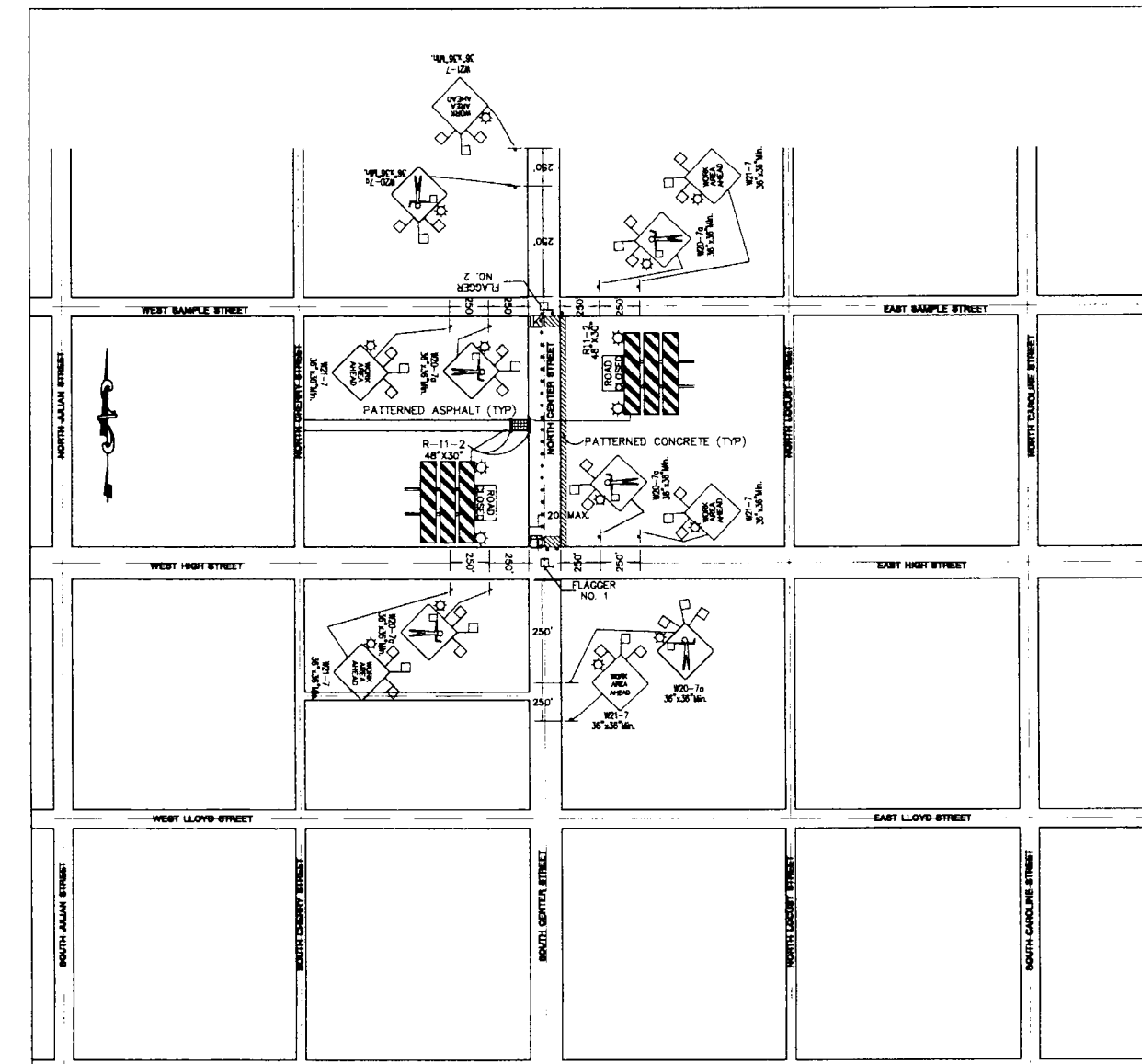

**PHASE 6**

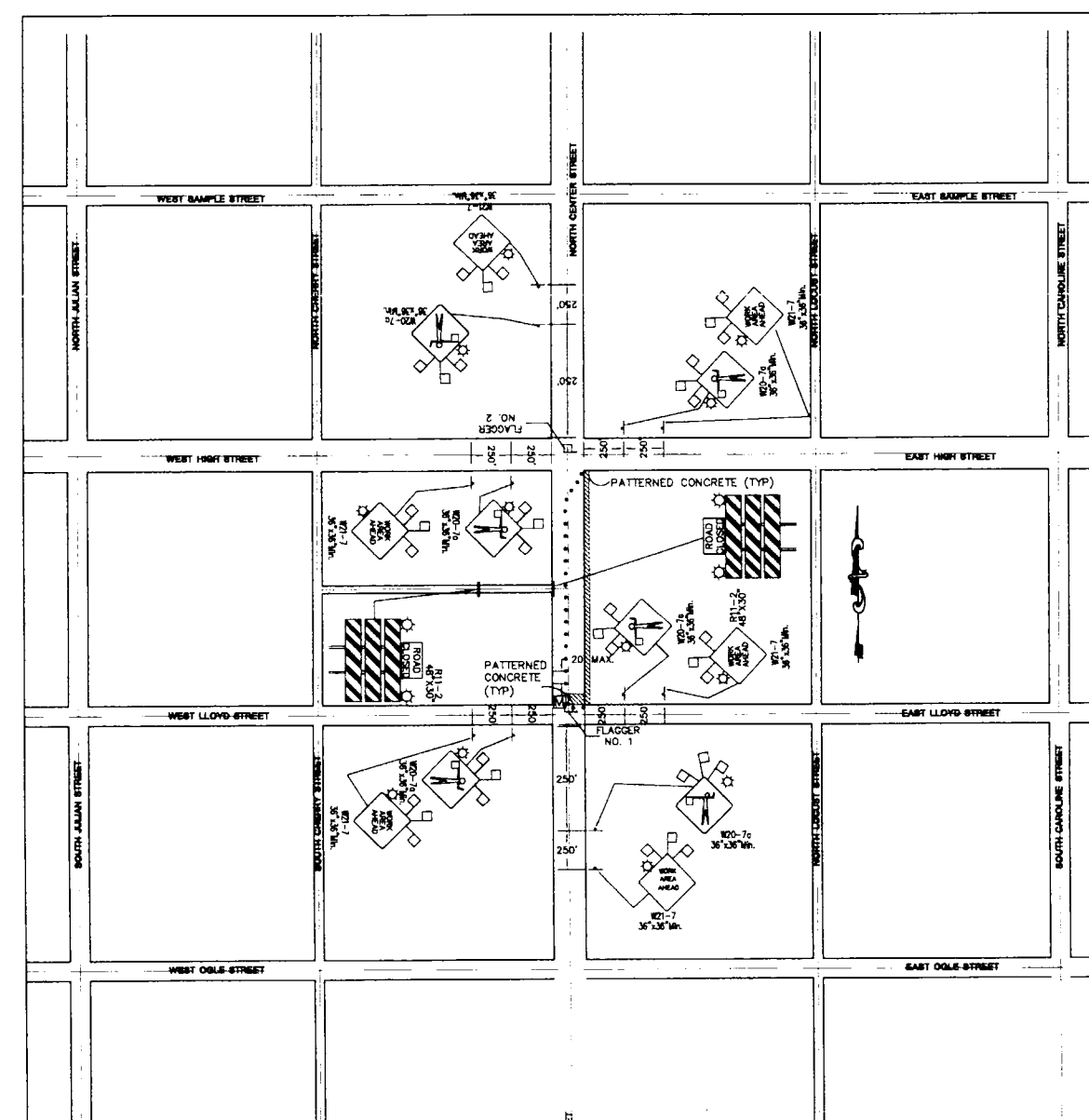

**PHASE 7**

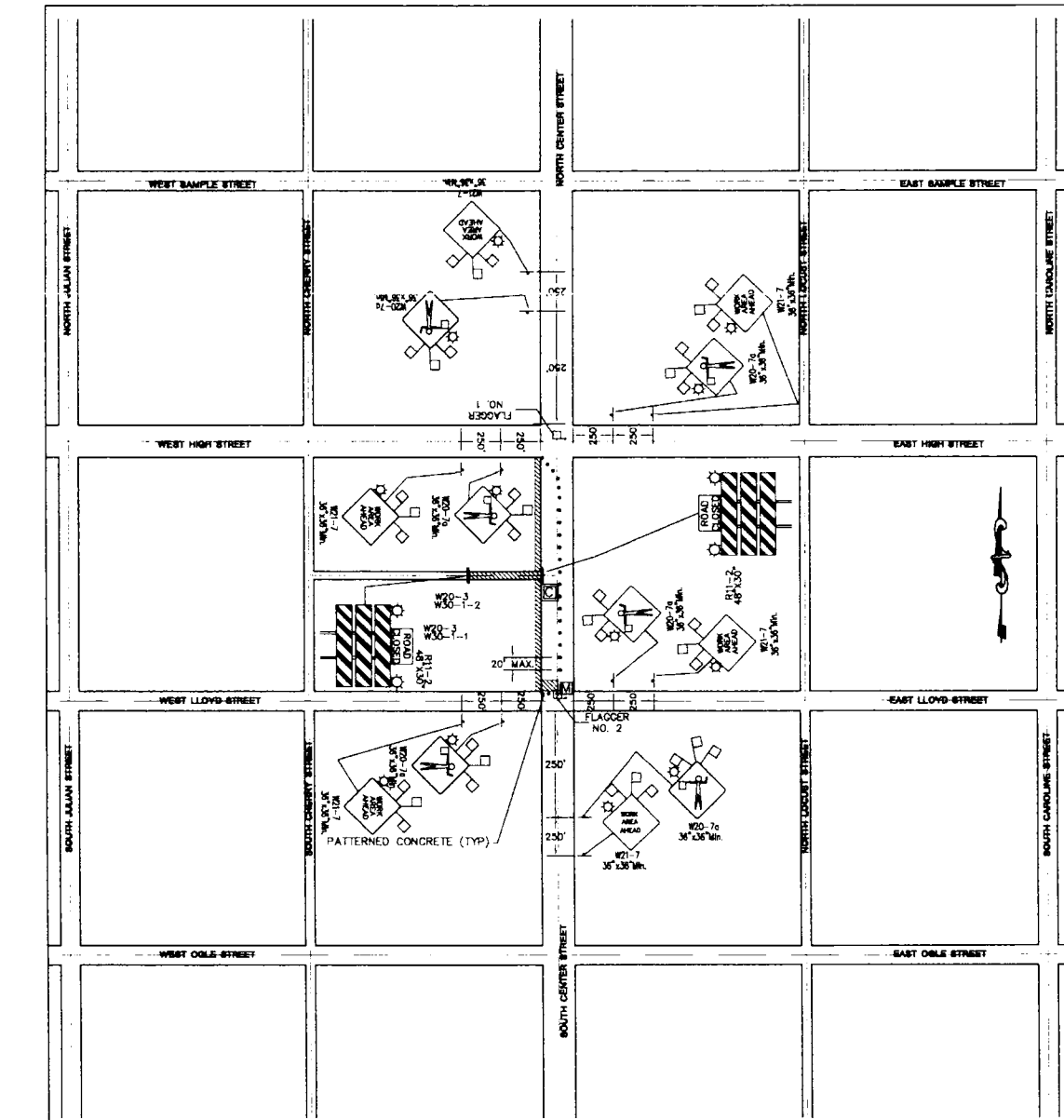

**PHASE 8**

NOTE: MINIMIZE PHYSICAL LENGTH OF ANY TRAVEL LANE CLOSURES. CLOSE ONLY THOSE PORTIONS OF TRAVEL LANES WHERE WORK IS IN ACTIVE PROGRESS

**SYMBOLS**

- WORK AREA
- SIGN
- TYPE B LIGHT
- CHANNELIZING DEVICE
- FLAGGER WITH A 24" X 24" REFLECTORIZED STOP/SLOW SIGN (W21-10) AND REFLECTIVE GARMENTS
- FLAGGER WITH A 24" X 24" RED FLAG AND REFLECTIVE GARMENTS.

*Committed*  
10-14-04



1 G-THING

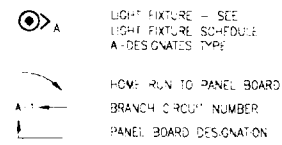

2 POWER

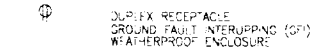

3 ABBREVIATIONS

A	AMPERES
A.F.G.	ABOVE FINISHED GRADE
C	CIRCUIT
CB	CIRCUIT BREAKER
CKT	CIRCUIT
EC	ELECTRICAL CONTRACTOR
EL	ELECTRICAL
G.C. OR G.C.A.	GENERAL CONTRACTOR
GC	GENERAL CONTRACTOR
GF	GROUND FAULT INTERRUPTING
HS	HOT SURFACE
IG	ISOLATED GROUND
L	LAMP
LCP	LIGHTING CONTROL PANEL
LCP	LIGHTING PANEL
MCB	MAIN CIRCUIT BREAKER
MCO	MAIN LUG ONLY
NC	NORMALLY CLOSED
NLC	NATIONAL ELECTRIC CODES
P	PUMP OR POLE
PNL	PANEL
PP	POWER PANEL
S.P.	SIZE LIGHTING PANEL
V	VOLTS
W	WIRE OR WIRE
W/P	WEATHERPROOF

4 GENERAL NOTES

- CONTRACTOR IS RESPONSIBLE FOR ENTIRE BID DOCUMENT SET, I.E. IF WORK IS SHOWN ON OTHER TRADE DRAWING AS BY ELECTRICAL CONTRACTOR, ELECTRICAL CONTRACTOR IS RESPONSIBLE FOR THAT WORK.
- COORDINATE LOCATION OF LIGHTING FIXTURES WITH OTHER TRADES.
- PROVIDE ALL LIGHTING FIXTURES WITH BALASTS, MASTER/SLAVE BALASTING IS NOT ACCEPTABLE. ALL BRANCH CIRCUITS TO HAVE ONE PHASE, ONE NEUTRAL AND ONE GROUND UNLESS OTHERWISE SPECIFIED.
- ALL ELECTRICAL CONDUIT AND WIRING IS TO BE INSTALLED UNDERGROUND, WHERE CONDUIT CROSS STREETS - CONDUIT IS TO BE INSTALLED UNDER STREET.

5 B

- CONTRACT LOCAL ELECTRIC UTILITY AND MAKE ALL ARRANGEMENTS AND PAY ALL COSTS IN CONNECTION WITH PROVIDING ELECTRICAL POWER AS SHOWN ON THE DRAWINGS.

6 A

7 ELECTRICAL SPECIFICATIONS

- WORK INCLUDES
  - ALL WORK SHALL BE MANUFACTURED, TESTED AND INSTALLED IN ACCORDANCE WITH THE NATIONAL ELECTRICAL CODE (NEC) AND THE TRADE PUBLICATIONS AS LATEST EDITION, HENDON ROADWAY CONSTRUCTION STANDARDS PER MS 700, AN AIR APPLICABLE DISTANCE AND PAY FOR ALL PERMITS AND CITY FEES, PAY ALL SALES TAX AS APPLICABLE.
  - THOROUGHLY EXAMINE THE CIVIL DRAWINGS PRIOR TO COMMENCEMENT OF ANY WORK, COORDINATE WORK WITH ALL OTHER TRADES.
  - THE CONTRACTOR SHALL VISIT THE JOB SITE PRIOR TO BID DATE TO EXAMINE THE CONDITIONS UNDER WHICH HIS WORK IS TO BE PERFORMED. NO EXTRAS SHALL BE ALLOWED FOR FAILURE TO NOTE EXISTING CONDITIONS.
  - ALL ELECTRICAL EQUIPMENT SHALL BE NEW, OF FIRST QUALITY, AND SHALL BE FURNISHED, DELIVERED, ERECTED, CONNECTED, AND INSTALLED IN EVERY DETAIL.
  - ONLY THOSE MATERIALS AND EQUIPMENT NAMED ON THE DOCUMENTS ARE ACCEPTABLE. SUBSTITUTIONS WILL NOT BE ACCEPTED.
  - IF THE CONTRACT DRAWINGS ARE DIAGNOSTIC AND INDICATE THE GENERAL ARRANGEMENT OF WORK INCLUDED IN THE CONTRACT, DO NOT SCALE THE DRAWINGS, DUE TO THE SMALL SCALE OF THE DRAWINGS, IT IS NOT POSSIBLE TO INDICATE ALL RADIWAY OFFSETS, RISERS AND DROPS FITTINGS, AND ACCESSORIES AS MAY BE REQUIRED TO MEET SUCH CONDITIONS.

- WARRANTY
  - THE CONTRACTOR SHALL LEAVE THE ENTIRE ELECTRICAL SYSTEM INSTALLED UNDER THIS CONTRACT IN PROPER WORKING ORDER AND SHALL WITHOUT ADDITIONAL CHARGE REPLACE ANY WORK OR MATERIAL, WHICH DEVELOPS DEFECTS FROM ORDINARY WEAR AND TEAR WITHIN ONE YEAR FROM DATE OF FINAL ACCEPTANCE.

- TESTS
  - THE CONTRACTOR SHALL FURNISH ALL EQUIPMENT AND APPLIANCES NECESSARY FOR TESTING THE COMPLETE WIRING SYSTEM DURING THE PROGRESS OF THE WORK, AS MAY BE DIRECTED BY THE ENGINEER. DEMONSTRATE TO THE SATISFACTION OF THE ENGINEER THAT ALL CIRCUITS ARE FREE FROM UNEXPECTED GROUNDS.

- SHOP DRAWINGS
  - WITHIN 15 DAYS AFTER AWARD OF THE CONTRACT, SUBMIT SIX (6) SETS OF SHOP DRAWINGS TO THE ENGINEER. ORDER MATERIAL ONLY AFTER RECEIVING APPROVED SHOP DRAWINGS.

- RACEWAYS
  - PROVIDE AND INSTALL PVC RACEWAY, UNLESS NOTED OTHERWISE, THE MINIMUM SIZE OF RACEWAY IS 1" CONCRETE ALL RACEWAYS SHALL BE INSTALLED AS TO INSURE AGAINST THE COLLECTION OF TRAPPED CONDENSATION ARRANGED TO BE FREE FROM TRAPS WHATEVER POSSIBLE. USE SCREW OR PUSH-IN CAPS TO PREVENT THE LOOSEMENT OF FOREIGN PARTICLES IN THE RACEWAYS. FITTINGS AND BOXES DURING CONSTRUCTION. ALL RACEWAYS MUST BE TRAPPED OUT BEFORE PULLING WIRE. PROVIDE FOR ALL SERVICE, FEEDER, BRANCH AND CONTROL WIRING.
  - ALL FEEDER AND BRANCH CIRCUIT CONDUCTORS SHALL BE COPPER RATED 600 VOLTS WITH 90% RH OR USE INSULATION MINIMUM SIZE BRANCH CIRCUIT CONDUCTOR SHALL BE #12, SIZE #12 AND #10 SHALL BE SOLID. CONDUCTORS SIZE #8 AND #10 SHALL BE STRANDED.
  - A GREEN COLORED INSULATED EQUIPMENT GROUND CONDUCTOR SHALL BE PROVIDED FOR EACH OF THE REQUIRED EQUIPMENT GROUNDING CONDUCTORS AND STRAPS SHALL BE SIZED IN COMPLIANCE WITH N.E.C. TABLE 250-95.

- OUTLET BOXES
  - PROVIDE AT EACH OUTLET OR DEVICE AN OUTLET BOX IN WHICH RACEWAYS AND CONDUCTORS SHALL TERMINATE.

- WIRING DEVICES
  - WIRING DEVICES SHALL BE AS MANUFACTURED BY HUBBELL BRYANT, ARROW-HART, OIL, M&S, OR LEVITON.

- DEVICE PLATES
  - PROVIDE DEVICE PLATES FOR ALL OUTLETS WHERE DEVICES ARE INSTALLED.

- FASTENERS AND SUPPORTS
  - ALL CONDUITS SHALL BE SECURELY AND INDEPENDENTLY SUPPORTED SO THAT NO STRAIN WILL BE TRANSMITTED TO OUTLET BOX SUPPORT SHALL BE RIGID ENOUGH TO PREVENT DISTORTION OF CONDUITS DURING WIRE PULLING.

- PANEL BOARDS
  - PANEL BOARDS SHALL COMPLY WITH NEMA IFR-1 AND BE CIRCUIT BREAKER TYPE. PANEL BOARD BUS SHALL BE COPPER WITH COPPER GROUND BUS. MINIMUM INTEGRATED SHORT CIRCUIT RATING: 22,000 AMPERES RMS SYMMETRICAL FOR 240 VOLT PANEL BOARDS.
  - MODULAR CIRCUIT BREAKERS - NEMA AB-7. PROVIDE CIRCUIT BREAKERS WITH INTERNAL THERMAL AND INSTANTANEOUS MAGNETIC TRIP IN EACH POLE. ENCLOSURE - NEMA 3R CABINET FRONT SURFACE PIPE. PROVIDE HINGED DOOR WITH TIE-BACK FASTEN IN MANUFACTURER'S STANDARD GRAY ENAMEL SPACES, WHERE NOT CALLED SHALL HAVE ALL BUS PROVISION. MANUFACTURER'S SHALL BE SIMENS, CUTLER-HAMMER, OR SQUARE-D.

- LIGHTING
  - LAMPS ALL FIXTURES SHALL BE COMPLETE WITH NEW LAMPS OF EITHER PHILIPS, GE, OR SYLVANIA MANUFACTURE.
  - FIXTURES SHALL BE AS INDICATED ON THE LIGHTING FIXTURE SCHEDULE AND INDICATE THE QUALITY OF EQUIPMENT THAT IS TO BE PROVIDED.
  - ACCEPTABLE BALASTS MANUFACTURERS ARE ADVANCE, MAGNEX, SYLVANIA OR EQUAL. PROVIDE DIMM BALAST FOR ALL FIXTURES.
  - PROVIDE METAL HALIDE PULSE START FIXTURES.

- GROUNDING
  - ALL GROUNDING AND BONDING SHALL COMPLY WITH ARTICLE 250 OF THE NEC. COPPER, SIZED PER NEC.
  - THE FOLLOWING EQUIPMENT SHALL BE SECURELY GROUND BY AN INSULATED COPPER CONDUCTOR SIZED PER TABLE 250-95. MINIMUM SIZE EQUIPMENT GROUNDING CONDUCTORS FOR GROUNDING RACEWAY AND EQUIPMENT: BRANCH CIRCUIT PANEL BOARDS, ALL EXTERIOR BRANCH CIRCUITS.

- POWER SUPPLIES
  - CONTRACT LOCAL ELECTRIC UTILITY AND MAKE ALL ARRANGEMENTS AND PAY ALL COSTS IN CONNECTION WITH PROVIDING ELECTRICAL POWER AS SHOWN ON THE DRAWINGS.

SECTION 178 - INTELLIGENT PANELBOARD  
 INTRODUCTION  
 THE WORK COVERED IN THIS SECTION IS SUBJECT TO ALL THE REQUIREMENTS AND THE GENERAL CONDITIONS OF THE SPECIFICATIONS. THE CONTRACTOR SHALL COORDINATE ALL OF THE WORK IN THIS SECTION WITH ALL OF THE TRADES COVERED IN OTHER SECTIONS OF THE SPECIFICATION TO PROVIDE A COMPLETE AND OPERABLE SYSTEM.

DESCRIPTION OF WORK  
 THE PORTION OF THE LIGHTING CONTROL SYSTEM WORK IS INDICATED BY THE DRAWINGS AND BY THE REQUIREMENTS OF THIS SECTION. IT IS DEEMED TO INCLUDE, BUT NOT BE LIMITED TO:  
 PANEL BOARDS CONTAINING 300% STANDARD AND REMOTELY OPERABLE CIRCUIT BREAKERS  
 CONTROL ELECTRONICS FOR MONITORING CIRCUIT BREAKER STATUS AND MONITORING THE STATUS OF THE SYSTEM  
 ASSOCIATED LOW VOLTAGE SWITCHES, OCCUPANCY SENSORS AND EXTERNAL TIME CLOCKS  
 ANY WORK STATIONS, SOFTWARE AND COMMUNICATIONS HARDWARE  
 SYSTEM INSTALLATION INCLUDING THE FOLLOWING:  
 WIRING OF MAIN AND BRANCH CIRCUIT CONDUCTORS  
 INSTALLATION OF EXTERNAL CONTROL DEVICES AND WIRING TO THE PANELBOARD CONTROLLER  
 INSTALLATION OF COMMUNICATIONS CONDUITS AND ASSOCIATED HARDWARE

QUALITY ASSURANCE  
 MANUFACTURERS FIRMS ENGAGED IN THE MANUFACTURE OF LIGHTING CONTROL EQUIPMENT AND AUXILIARY EQUIPMENT OF THE TYPES INDICATED, WHOSE PRODUCTS HAVE BEEN IN SATISFACTORY USE IN SIMILAR SERVICE FOR NOT LESS THAN FIVE YEARS.  
 COMPONENT TESTING - ALL ELECTRICAL COMPONENT BOARD ASSEMBLIES ARE TO BE FACTORY TESTED AND BURNED IN PRIOR TO INSTALLATION.

SYSTEM SUPPORT - FACTORY AND/OR ONE/YEAR SUPPORT SHALL BE AVAILABLE FREE OF CHARGE DURING NORMAL BUSINESS HOURS.  
 NEMA COMPLIANCE - COMPLY WITH APPLICABLE PORTIONS OF NEMA STANDARDS PERTAINING TO TYPES OF ELECTRICAL EQUIPMENT AND ENCLOSURES.  
 NEC COMPLIANCE - COMPLY WITH APPLICABLE PORTIONS OF THE NEC INCLUDING ARTICLES 110-10 AND 220.  
 UL COMPLIANCE - COMPLY WITH APPLICABLE UL STANDARDS FOR PANELBOARDS, CIRCUIT BREAKERS AND ENERGY MANAGEMENT EQUIPMENT.  
 EMC EMISSIONS - ALL ASSEMBLIES ARE TO BE IN COMPLIANCE WITH FCC EMISSIONS STANDARDS SPECIFIED IN PART 15, SUBPART C, FOR CLASS A APPLICATIONS.  
 EMC IMMUNITY - IEC 1000 LEVEL 4.  
 ESD SUSCEPTIBILITY - IEC 1000 LEVEL 3.  
 ELECTRICAL PART TRANSIENT SUSCEPTIBILITY - IEC 1000 LEVEL 3.  
 ELECTRICAL SURGE SUSCEPTIBILITY - POWER LINE IEC 1000 LEVEL 4.  
 ELECTRICAL SURGE SUSCEPTIBILITY - INTERCOMMUNICATION LINE IEC 1000 LEVEL 3.  
 ISO 9001 MANUFACTURE OF MATERIALS AND SOFTWARE COMPONENTS SHALL BE REGISTERED AS ISO 9001 COMPLIANT.

WARRANTY  
 MANUFACTURER SHALL WARRANT SPECIFIED EQUIPMENT TO BE FREE FROM DEFECTS IN MATERIALS AND WORKMANSHIP FOR THE LESSER OF ONE YEAR FROM THE DATE OF INSTALLATION OR EIGHTEEN MONTHS FROM DATE OF PURCHASE.

SUBMITTALS  
 PRODUCT DATA SHEETS - SUBMIT MANUFACTURER'S DATA SHEET FOR THE LIGHTING CONTROL SYSTEM AND SPECIFIED COMPONENTS.  
 PANEL DRAWINGS - SUBMIT MANUFACTURER'S DIMENSIONAL DRAWINGS AND CIRCUIT BREAKER PLACEMENT LOCATIONS FOR EACH PANELBOARD.  
 ONE LINE DIAGRAM - SUBMIT A ONE LINE DIAGRAM OF THE SYSTEM INCLUDING PROPOSED TYPICAL CONNECTIONS TO EXTERNAL LOW VOLTAGE (24 VOLT OR 3P 4W) SWITCH CONTACTS.  
 THE LIGHTING CONTROL SYSTEM SHALL MEET OR EXCEED THE FOLLOWING CAPABILITIES:  
 SYSTEM (1) 7 WIRE (2) WIRE (3) WIRE (4) WIRE (5) WIRE (6) WIRE (7) WIRE (8) WIRE (9) WIRE (10) WIRE (11) WIRE (12) WIRE (13) WIRE (14) WIRE (15) WIRE (16) WIRE (17) WIRE (18) WIRE (19) WIRE (20) WIRE (21) WIRE (22) WIRE (23) WIRE (24) WIRE (25) WIRE (26) WIRE (27) WIRE (28) WIRE (29) WIRE (30) WIRE (31) WIRE (32) WIRE (33) WIRE (34) WIRE (35) WIRE (36) WIRE (37) WIRE (38) WIRE (39) WIRE (40) WIRE (41) WIRE (42) WIRE (43) WIRE (44) WIRE (45) WIRE (46) WIRE (47) WIRE (48) WIRE (49) WIRE (50) WIRE (51) WIRE (52) WIRE (53) WIRE (54) WIRE (55) WIRE (56) WIRE (57) WIRE (58) WIRE (59) WIRE (60) WIRE (61) WIRE (62) WIRE (63) WIRE (64) WIRE (65) WIRE (66) WIRE (67) WIRE (68) WIRE (69) WIRE (70) WIRE (71) WIRE (72) WIRE (73) WIRE (74) WIRE (75) WIRE (76) WIRE (77) WIRE (78) WIRE (79) WIRE (80) WIRE (81) WIRE (82) WIRE (83) WIRE (84) WIRE (85) WIRE (86) WIRE (87) WIRE (88) WIRE (89) WIRE (90) WIRE (91) WIRE (92) WIRE (93) WIRE (94) WIRE (95) WIRE (96) WIRE (97) WIRE (98) WIRE (99) WIRE (100) WIRE (101) WIRE (102) WIRE (103) WIRE (104) WIRE (105) WIRE (106) WIRE (107) WIRE (108) WIRE (109) WIRE (110) WIRE (111) WIRE (112) WIRE (113) WIRE (114) WIRE (115) WIRE (116) WIRE (117) WIRE (118) WIRE (119) WIRE (120) WIRE (121) WIRE (122) WIRE (123) WIRE (124) WIRE (125) WIRE (126) WIRE (127) WIRE (128) WIRE (129) WIRE (130) WIRE (131) WIRE (132) WIRE (133) WIRE (134) WIRE (135) WIRE (136) WIRE (137) WIRE (138) WIRE (139) WIRE (140) WIRE (141) WIRE (142) WIRE (143) WIRE (144) WIRE (145) WIRE (146) WIRE (147) WIRE (148) WIRE (149) WIRE (150) WIRE (151) WIRE (152) WIRE (153) WIRE (154) WIRE (155) WIRE (156) WIRE (157) WIRE (158) WIRE (159) WIRE (160) WIRE (161) WIRE (162) WIRE (163) WIRE (164) WIRE (165) WIRE (166) WIRE (167) WIRE (168) WIRE (169) WIRE (170) WIRE (171) WIRE (172) WIRE (173) WIRE (174) WIRE (175) WIRE (176) WIRE (177) WIRE (178) WIRE (179) WIRE (180) WIRE (181) WIRE (182) WIRE (183) WIRE (184) WIRE (185) WIRE (186) WIRE (187) WIRE (188) WIRE (189) WIRE (190) WIRE (191) WIRE (192) WIRE (193) WIRE (194) WIRE (195) WIRE (196) WIRE (197) WIRE (198) WIRE (199) WIRE (200) WIRE (201) WIRE (202) WIRE (203) WIRE (204) WIRE (205) WIRE (206) WIRE (207) WIRE (208) WIRE (209) WIRE (210) WIRE (211) WIRE (212) WIRE (213) WIRE (214) WIRE (215) WIRE (216) WIRE (217) WIRE (218) WIRE (219) WIRE (220) WIRE (221) WIRE (222) WIRE (223) WIRE (224) WIRE (225) WIRE (226) WIRE (227) WIRE (228) WIRE (229) WIRE (230) WIRE (231) WIRE (232) WIRE (233) WIRE (234) WIRE (235) WIRE (236) WIRE (237) WIRE (238) WIRE (239) WIRE (240) WIRE (241) WIRE (242) WIRE (243) WIRE (244) WIRE (245) WIRE (246) WIRE (247) WIRE (248) WIRE (249) WIRE (250) WIRE (251) WIRE (252) WIRE (253) WIRE (254) WIRE (255) WIRE (256) WIRE (257) WIRE (258) WIRE (259) WIRE (260) WIRE (261) WIRE (262) WIRE (263) WIRE (264) WIRE (265) WIRE (266) WIRE (267) WIRE (268) WIRE (269) WIRE (270) WIRE (271) WIRE (272) WIRE (273) WIRE (274) WIRE (275) WIRE (276) WIRE (277) WIRE (278) WIRE (279) WIRE (280) WIRE (281) WIRE (282) WIRE (283) WIRE (284) WIRE (285) WIRE (286) WIRE (287) WIRE (288) WIRE (289) WIRE (290) WIRE (291) WIRE (292) WIRE (293) WIRE (294) WIRE (295) WIRE (296) WIRE (297) WIRE (298) WIRE (299) WIRE (300) WIRE (301) WIRE (302) WIRE (303) WIRE (304) WIRE (305) WIRE (306) WIRE (307) WIRE (308) WIRE (309) WIRE (310) WIRE (311) WIRE (312) WIRE (313) WIRE (314) WIRE (315) WIRE (316) WIRE (317) WIRE (318) WIRE (319) WIRE (320) WIRE (321) WIRE (322) WIRE (323) WIRE (324) WIRE (325) WIRE (326) WIRE (327) WIRE (328) WIRE (329) WIRE (330) WIRE (331) WIRE (332) WIRE (333) WIRE (334) WIRE (335) WIRE (336) WIRE (337) WIRE (338) WIRE (339) WIRE (340) WIRE (341) WIRE (342) WIRE (343) WIRE (344) WIRE (345) WIRE (346) WIRE (347) WIRE (348) WIRE (349) WIRE (350) WIRE (351) WIRE (352) WIRE (353) WIRE (354) WIRE (355) WIRE (356) WIRE (357) WIRE (358) WIRE (359) WIRE (360) WIRE (361) WIRE (362) WIRE (363) WIRE (364) WIRE (365) WIRE (366) WIRE (367) WIRE (368) WIRE (369) WIRE (370) WIRE (371) WIRE (372) WIRE (373) WIRE (374) WIRE (375) WIRE (376) WIRE (377) WIRE (378) WIRE (379) WIRE (380) WIRE (381) WIRE (382) WIRE (383) WIRE (384) WIRE (385) WIRE (386) WIRE (387) WIRE (388) WIRE (389) WIRE (390) WIRE (391) WIRE (392) WIRE (393) WIRE (394) WIRE (395) WIRE (396) WIRE (397) WIRE (398) WIRE (399) WIRE (400) WIRE (401) WIRE (402) WIRE (403) WIRE (404) WIRE (405) WIRE (406) WIRE (407) WIRE (408) WIRE (409) WIRE (410) WIRE (411) WIRE (412) WIRE (413) WIRE (414) WIRE (415) WIRE (416) WIRE (417) WIRE (418) WIRE (419) WIRE (420) WIRE (421) WIRE (422) WIRE (423) WIRE (424) WIRE (425) WIRE (426) WIRE (427) WIRE (428) WIRE (429) WIRE (430) WIRE (431) WIRE (432) WIRE (433) WIRE (434) WIRE (435) WIRE (436) WIRE (437) WIRE (438) WIRE (439) WIRE (440) WIRE (441) WIRE (442) WIRE (443) WIRE (444) WIRE (445) WIRE (446) WIRE (447) WIRE (448) WIRE (449) WIRE (450) WIRE (451) WIRE (452) WIRE (453) WIRE (454) WIRE (455) WIRE (456) WIRE (457) WIRE (458) WIRE (459) WIRE (460) WIRE (461) WIRE (462) WIRE (463) WIRE (464) WIRE (465) WIRE (466) WIRE (467) WIRE (468) WIRE (469) WIRE (470) WIRE (471) WIRE (472) WIRE (473) WIRE (474) WIRE (475) WIRE (476) WIRE (477) WIRE (478) WIRE (479) WIRE (480) WIRE (481) WIRE (482) WIRE (483) WIRE (484) WIRE (485) WIRE (486) WIRE (487) WIRE (488) WIRE (489) WIRE (490) WIRE (491) WIRE (492) WIRE (493) WIRE (494) WIRE (495) WIRE (496) WIRE (497) WIRE (498) WIRE (499) WIRE (500) WIRE (501) WIRE (502) WIRE (503) WIRE (504) WIRE (505) WIRE (506) WIRE (507) WIRE (508) WIRE (509) WIRE (510) WIRE (511) WIRE (512) WIRE (513) WIRE (514) WIRE (515) WIRE (516) WIRE (517) WIRE (518) WIRE (519) WIRE (520) WIRE (521) WIRE (522) WIRE (523) WIRE (524) WIRE (525) WIRE (526) WIRE (527) WIRE (528) WIRE (529) WIRE (530) WIRE (531) WIRE (532) WIRE (533) WIRE (534) WIRE (535) WIRE (536) WIRE (537) WIRE (538) WIRE (539) WIRE (540) WIRE (541) WIRE (542) WIRE (543) WIRE (544) WIRE (545) WIRE (546) WIRE (547) WIRE (548) WIRE (549) WIRE (550) WIRE (551) WIRE (552) WIRE (553) WIRE (554) WIRE (555) WIRE (556) WIRE (557) WIRE (558) WIRE (559) WIRE (560) WIRE (561) WIRE (562) WIRE (563) WIRE (564) WIRE (565) WIRE (566) WIRE (567) WIRE (568) WIRE (569) WIRE (570) WIRE (571) WIRE (572) WIRE (573) WIRE (574) WIRE (575) WIRE (576) WIRE (577) WIRE (578) WIRE (579) WIRE (580) WIRE (581) WIRE (582) WIRE (583) WIRE (584) WIRE (585) WIRE (586) WIRE (587) WIRE (588) WIRE (589) WIRE (590) WIRE (591) WIRE (592) WIRE (593) WIRE (594) WIRE (595) WIRE (596) WIRE (597) WIRE (598) WIRE (599) WIRE (600) WIRE (601) WIRE (602) WIRE (603) WIRE (604) WIRE (605) WIRE (606) WIRE (607) WIRE (608) WIRE (609) WIRE (610) WIRE (611) WIRE (612) WIRE (613) WIRE (614) WIRE (615) WIRE (616) WIRE (617) WIRE (618) WIRE (619) WIRE (620) WIRE (621) WIRE (622) WIRE (623) WIRE (624) WIRE (625) WIRE (626) WIRE (627) WIRE (628) WIRE (629) WIRE (630) WIRE (631) WIRE (632) WIRE (633) WIRE (634) WIRE (635) WIRE (636) WIRE (637) WIRE (638) WIRE (639) WIRE (640) WIRE (641) WIRE (642) WIRE (643) WIRE (644) WIRE (645) WIRE (646) WIRE (647) WIRE (648) WIRE (649) WIRE (650) WIRE (651) WIRE (652) WIRE (653) WIRE (654) WIRE (655) WIRE (656) WIRE (657) WIRE (658) WIRE (659) WIRE (660) WIRE (661) WIRE (662) WIRE (663) WIRE (664) WIRE (665) WIRE (666) WIRE (667) WIRE (668) WIRE (669) WIRE (670) WIRE (671) WIRE (672) WIRE (673) WIRE (674) WIRE (675) WIRE (676) WIRE (677) WIRE (678) WIRE (679) WIRE (680) WIRE (681) WIRE (682) WIRE (683) WIRE (684) WIRE (685) WIRE (686) WIRE (687) WIRE (688) WIRE (689) WIRE (690) WIRE (691) WIRE (692) WIRE (693) WIRE (694) WIRE (695) WIRE (696) WIRE (697) WIRE (698) WIRE (699) WIRE (700) WIRE (701) WIRE (702) WIRE (703) WIRE (704) WIRE (705) WIRE (706) WIRE (707) WIRE (708) WIRE (709) WIRE (710) WIRE (711) WIRE (712) WIRE (713) WIRE (714) WIRE (715) WIRE (716) WIRE (717) WIRE (718) WIRE (719) WIRE (720) WIRE (721) WIRE (722) WIRE (723) WIRE (724) WIRE (725) WIRE (726) WIRE (727) WIRE (728) WIRE (729) WIRE (730) WIRE (731) WIRE (732) WIRE (733) WIRE (734) WIRE (735) WIRE (736) WIRE (737) WIRE (738) WIRE (739) WIRE (740) WIRE (741) WIRE (742) WIRE (743) WIRE (744) WIRE (745) WIRE (746) WIRE (747) WIRE (748) WIRE (749) WIRE (750) WIRE (751) WIRE (752) WIRE (753) WIRE (754) WIRE (755) WIRE (756) WIRE (757) WIRE (758) WIRE (759) WIRE (760) WIRE (761) WIRE (762) WIRE (763) WIRE (764) WIRE (765) WIRE (766) WIRE (767) WIRE (768) WIRE (769) WIRE (770) WIRE (771) WIRE (772) WIRE (773) WIRE (774) WIRE (775) WIRE (776) WIRE (777) WIRE (778) WIRE (779) WIRE (780) WIRE (781) WIRE (782) WIRE (783) WIRE (784) WIRE (785) WIRE (786) WIRE (787) WIRE (788) WIRE (789) WIRE (790) WIRE (791) WIRE (792) WIRE (793) WIRE (794) WIRE (795) WIRE (796) WIRE (797) WIRE (798) WIRE (799) WIRE (800) WIRE (801) WIRE (802) WIRE (803) WIRE (804) WIRE (805) WIRE (806) WIRE (807) WIRE (808) WIRE (809) WIRE (810) WIRE (811) WIRE (812) WIRE (813) WIRE (814) WIRE (815) WIRE (816) WIRE (817) WIRE (818) WIRE (819) WIRE (820) WIRE (821) WIRE (822) WIRE (823) WIRE (824) WIRE (825) WIRE (826) WIRE (827) WIRE (828) WIRE (829) WIRE (830) WIRE (831) WIRE (832) WIRE (833) WIRE (834) WIRE (835) WIRE (836) WIRE (837) WIRE (838) WIRE (839) WIRE (840) WIRE (841) WIRE (842) WIRE (843) WIRE (844) WIRE (845) WIRE (846) WIRE (847) WIRE (848) WIRE (849) WIRE (850) WIRE (851) WIRE (852) WIRE (853) WIRE (854) WIRE (855) WIRE (856) WIRE (857) WIRE (858) WIRE (859) WIRE (860) WIRE (861) WIRE (862) WIRE (863) WIRE (864) WIRE (865) WIRE (866) WIRE (867) WIRE (868) WIRE (869) WIRE (870) WIRE (871) WIRE (872) WIRE (873) WIRE (874) WIRE (875) WIRE (876) WIRE (877) WIRE (878) WIRE (879) WIRE (880) WIRE (881) WIRE (882) WIRE (883) WIRE (884) WIRE (885) WIRE (886) WIRE (887) WIRE (888) WIRE (889) WIRE (890) WIRE (891) WIRE (892) WIRE (893) WIRE (894) WIRE (895) WIRE (896) WIRE (897) WIRE (898) WIRE (899) WIRE (900) WIRE (901) WIRE (902) WIRE (903) WIRE (904) WIRE (905) WIRE (906) WIRE (907) WIRE (908) WIRE (909) WIRE (910) WIRE (911) WIRE (912) WIRE (913) WIRE (914) WIRE (915) WIRE (916) WIRE (917) WIRE (918) WIRE (919) WIRE (920) WIRE (921) WIRE (922) WIRE (923) WIRE (924) WIRE (925) WIRE (926) WIRE (927) WIRE (928) WIRE (929) WIRE (930) WIRE (931) WIRE (932) WIRE (933) WIRE (934) WIRE (935) WIRE (936) WIRE (937) WIRE (938) WIRE (939) WIRE (940) WIRE (941) WIRE (942) WIRE (943) WIRE (944) WIRE (945) WIRE (946) WIRE (947) WIRE (948) WIRE (949) WIRE (950) WIRE (951) WIRE (952) WIRE (953) WIRE (954) WIRE (955) WIRE (956) WIRE (957) WIRE (958) WIRE (959) WIRE (960) WIRE (961) WIRE (962) WIRE (963) WIRE (964) WIRE (965) WIRE (966) WIRE (967) WIRE (968) WIRE (969) WIRE (970) WIRE (971) WIRE (972) WIRE (973) WIRE (974) WIRE (975) WIRE (976) WIRE (977) WIRE (978) WIRE (979) WIRE (980) WIRE (981) WIRE (982) WIRE (983) WIRE (984) WIRE (985) WIRE (986) WIRE (987) WIRE (988) WIRE (989) WIRE (990) WIRE (991) WIRE (992) WIRE (993) WIRE (994) WIRE (995) WIRE (996) WIRE (997) WIRE (998) WIRE (999) WIRE (1000) WIRE (1001) WIRE (1002) WIRE (1003) WIRE (1004) WIRE (1005) WIRE (1006) WIRE (1007) WIRE (1008) WIRE (1009) WIRE (1010) WIRE (1011) WIRE (1012) WIRE (1013) WIRE (1014) WIRE (1015) WIRE (1016) WIRE (1017) WIRE (1018) WIRE (1019) WIRE (1020) WIRE (1021) WIRE (1022) WIRE (1023) WIRE (1024) WIRE (1025) WIRE (1026) WIRE (1027) WIRE (1028) WIRE (1029) WIRE (1030) WIRE (1031) WIRE (1032) WIRE (1033) WIRE (1034) WIRE (1035) WIRE (1036) WIRE (1037) WIRE (1038) WIRE (1039) WIRE (1040) WIRE (1041) WIRE (1042) WIRE (1043) WIRE (1044) WIRE (1045) WIRE (1046) WIRE (1047) WIRE (1048) WIRE (1049) WIRE (1050) WIRE (1051) WIRE (1052) WIRE (1053) WIRE (1054) WIRE (1055) WIRE (1056) WIRE (1057) WIRE (1058) WIRE (1059) WIRE (1060) WIRE (1061) WIRE (1062) WIRE (1063) WIRE (1064) WIRE (1065) WIRE (1066) WIRE (1067) WIRE (1068) WIRE (1069) WIRE (1070) WIRE (1071) WIRE (1072) WIRE (1073) WIRE (1074) WIRE (1075) WIRE (1076) WIRE (1077) WIRE (1078) WIRE (1079) WIRE (1080) WIRE (1081) WIRE (1082) WIRE (1083) WIRE (1084) WIRE (1085) WIRE (1086) WIRE (1087) WIRE (1088) WIRE (1089) WIRE (1090) WIRE (1091) WIRE (1092) WIRE (1093) WIRE (





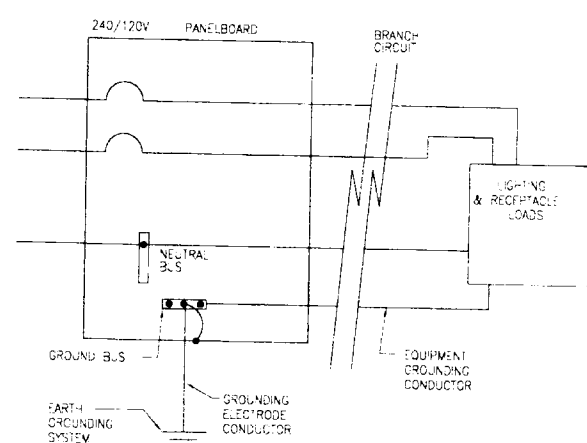

1 DETAIL - GROUNDING SYSTEM  
N.T.S.

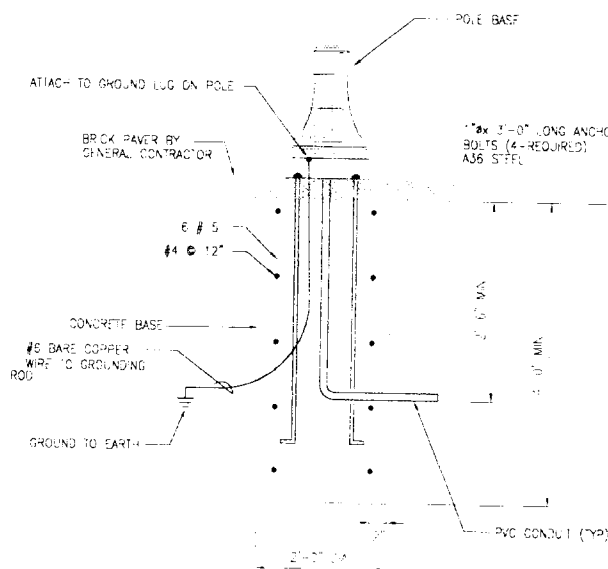

2 DETAIL - LIGHT POLE BASE  
N.T.S.

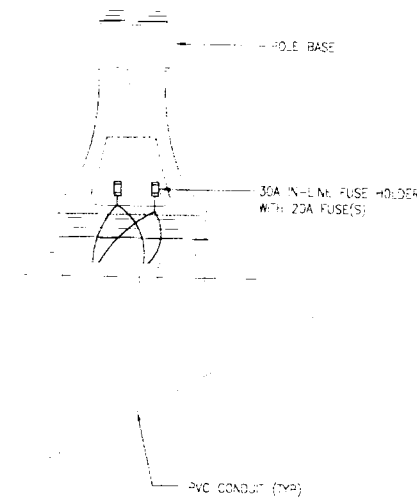

3 DETAIL - LIGHT POLE WIRING DIAGRAM (TYP.)  
N.T.S.

TYPE	DESCRIPTION	MANUFACTURER	AMPS	VOLTAGE
A	LUMINAIRE TYPE 3 DISTRIBUTION POLE FOR TYPE A	SEE SPECIAL PROVISIONS	100W MH	240
B	LUMINAIRE TYPE 4 DISTRIBUTION POLE FOR TYPE B	SEE SPECIAL PROVISIONS	100W MH	240

MASTER SMART PANELBOARD SCHEDULE										RPA									
MOUNTING: SURFACE 10000										MOUNTING: SURFACE 10000									
NO	PH	LOAD KW	DESCRIPTION	WIRE	C/B	C/B	LOAD KW	DESCRIPTION	WIRE	PH	NO	NO	PH	NO	NO	PH	NO		
1	A	0.36	RECEP ON POLE	#12	20/1	20/2	0.63	LIGHT POLES	#12	A	2	1	A	2	1	A	2		
3	B	0.54	RECEP ON POLE	#12	20/1	20/2	0.63	LIGHT POLES	#12	B	4	3	B	4	3	B	4		
5	A	0.54	RECEP ON POLE	#12	20/1	20/2	0.63	LIGHT POLES	#12	A	6	5	A	6	5	A	6		
7	B	0.54	RECEP ON POLE	#12	20/1	20/2	0.63	LIGHT POLES	#12	B	8	7	B	8	7	B	8		
9	A	0.36	RECEP ON POLE	#10	20/1	20/2	0.63	LIGHT POLES	#10	A	10	9	A	10	9	A	10		
11	B	0.36	RECEP ON POLE	#10	20/1	20/2	0.63	LIGHT POLES	#10	B	12	11	B	12	11	B	12		
13	A		SPARE				0.63	LIGHT POLES		A	14	13	A	14	13	A	14		
15	B		SPARE				0.63	LIGHT POLES		B	16	15	B	16	15	B	16		
17	A		SPARE				0.63	LIGHT POLES		A	18	17	A	18	17	A	18		
19	B		SPARE				0.63	LIGHT POLES		B	20	19	B	20	19	B	20		
21	A		SPARE				0.63	LIGHT POLES		A	22	21	A	22	21	A	22		
23	B	0.54	RECEP ON POLE	#10	20/1	20/2	0.63	LIGHT POLES	#10	B	24	23	B	24	23	B	24		
25	A	0.54	RECEP ON POLE	#10	20/1	20/2	0.63	LIGHT POLES	#10	A	26	25	A	26	25	A	26		
27	B	0.36	RECEP ON POLE	#10	20/1	20/2	0.63	LIGHT POLES	#10	B	28	27	B	28	27	B	28		
29	A		SPARE				0.63	LIGHT POLES		A	30	29	A	30	29	A	30		
			SPARE				0.63	LIGHT POLES		B	32								
A		0.62					4.12			A	28	A		28	A		28		
B		0.98					4.48			B	30	B		30	B		30		
TOTALS												TOTALS		TOTALS		TOTALS			
							4.72												
							4.48												

SLAVE SMART PANELBOARD SCHEDULE										RPB									
MOUNTING: SURFACE 10000										MOUNTING: SURFACE 10000									
NO	PH	LOAD KW	DESCRIPTION	WIRE	C/B	C/B	LOAD KW	DESCRIPTION	WIRE	PH	NO	NO	PH	NO	NO	PH	NO		
1	A		SPARE				0.32	LIGHT POLES	#12	A	2	1	A	2	1	A	2		
3	B		SPARE				0.32	LIGHT POLES	#12	B	4	3	B	4	3	B	4		
5	A		SPARE				0.32	LIGHT POLES	#12	A	6	5	A	6	5	A	6		
7	B		SPARE				0.32	LIGHT POLES	#12	B	8	7	B	8	7	B	8		
9	A	0.72	RECEP ON POLE	#10	20/1	20/2	0.32	LIGHT POLES	#10	A	10	9	A	10	9	A	10		
11	B	0.36	RECEP ON POLE	#10	20/1	20/2	0.32	LIGHT POLES	#10	B	12	11	B	12	11	B	12		
13	A	0.54	RECEP ON POLE	#8	20/1	20/2	0.32	LIGHT POLES	#8	A	14	13	A	14	13	A	14		
15	B	0.54	RECEP ON POLE	#8	20/1	20/2	0.32	LIGHT POLES	#8	B	16	15	B	16	15	B	16		
17	A	0.54	RECEP ON POLE	#12	20/1	20/2	0.54	SPACE		A	18	17	A	18	17	A	18		
19	B	0.36	RECEP ON POLE	#12	20/1	20/2	0.54	SPACE		B	20	19	B	20	19	B	20		
21	A	0.54	RECEP ON POLE	#10	20/1	20/2	0.54	SPACE		A	22	21	A	22	21	A	22		
23	B	0.54	RECEP ON POLE	#10	20/1	20/2	0.54	SPACE		B	24	23	B	24	23	B	24		
25	A		SPARE				0.54	SPACE		A	26	25	A	26	25	A	26		
27	B		SPARE				0.54	SPACE		B	28	27	B	28	27	B	28		
29	A		SPARE				0.54	SPACE		A	30	29	A	30	29	A	30		
			SPARE				0.54	SPACE		B	32								
A		2.34					1.28			A	28	A		28	A		28		
B		0.98					2.36			B	30	B		30	B		30		
TOTALS												TOTALS		TOTALS		TOTALS			
							5.62												
							24.92												

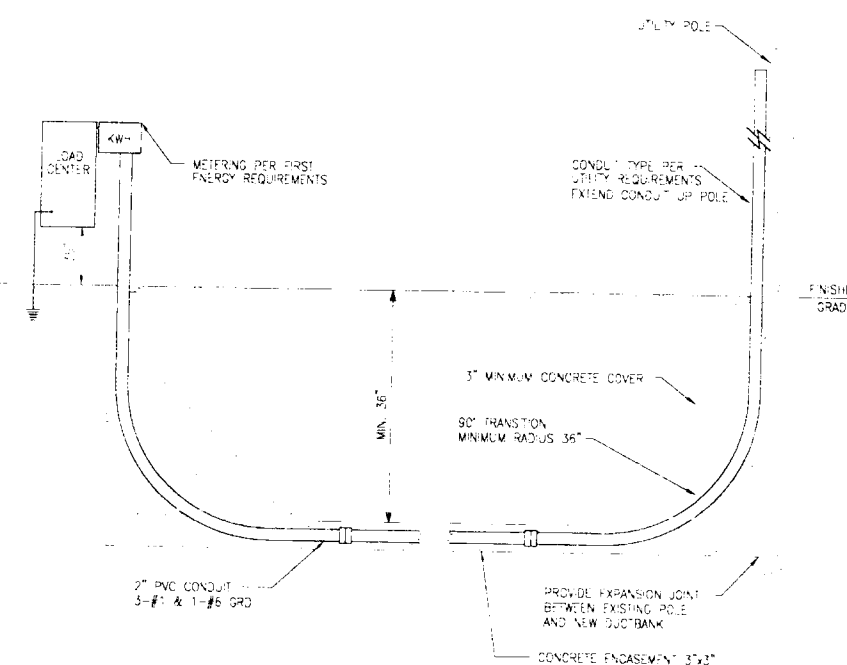

4 DETAIL - SERVICE ENTRANCE  
N.T.S.

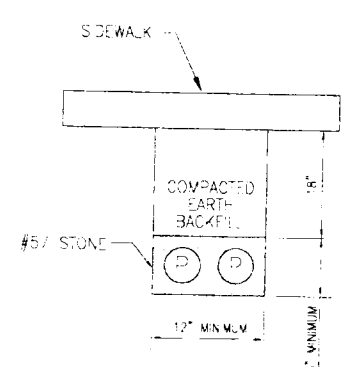

5 DETAIL - TRENCH  
N.T.S.

SLAVE SMART PANELBOARD SCHEDULE										RPC									
MOUNTING: SURFACE 10000										MOUNTING: SURFACE 10000									
NO	PH	LOAD KW	DESCRIPTION	WIRE	C/B	C/B	LOAD KW	DESCRIPTION	WIRE	PH	NO	NO	PH	NO	NO	PH	NO		
1	A		SPARE				0.63	LIGHT POLES	#12	A	2	1	A	2	1	A	2		
3	B		SPARE				0.63	LIGHT POLES	#12	B	4	3	B	4	3	B	4		
5	A		SPARE				0.63	LIGHT POLES	#12	A	6	5	A	6	5	A	6		
7	B		SPARE				0.63	LIGHT POLES	#12	B	8	7	B	8	7	B	8		
9	A	0.36	RECEP ON POLE	#10	20/1	20/2	0.63	LIGHT POLES	#10	A	10	9	A	10	9	A	10		
11	B	0.36	RECEP ON POLE	#10	20/1	20/2	0.63	LIGHT POLES	#10	B	12	11	B	12	11	B	12		
13	A	0.36	RECEP ON POLE	#10	20/1	20/2	0.63	LIGHT POLES	#10	A	14	13	A	14	13	A	14		
15	B	0.36	RECEP ON POLE	#10	20/1	20/2	0.63	LIGHT POLES	#10	B	16	15	B	16	15	B	16		
17	A	2.54	RECEP ON POLE	#12	20/1	20/2	0.63	LIGHT POLES	#12	A	18	17	A	18	17	A	18		
19	B	0.54	RECEP ON POLE	#12	20/1	20/2	0.63	LIGHT POLES	#12	B	20	19	B	20	19	B	20		
21	A	2.84	RECEP ON POLE	#12	20/1	20/2	0.63	LIGHT POLES	#12	A	22	21	A	22	21	A	22		
23	B	0.36	RECEP ON POLE	#12	20/1	20/2	0.63	LIGHT POLES	#12	B	24	23	B	24	23	B	24		
25	A	0.54	RECEP ON POLE	#10	20/1	20/2	0.63	LIGHT POLES	#10	A	26	25	A	26	25	A	26		
27	B	0.54	RECEP ON POLE	#10	20/1	20/2	0.63	LIGHT POLES	#10	B	28	27	B	28	27	B	28		
29	A	0.36	RECEP ON POLE	#12	20/1	20/2	0.63	LIGHT POLES	#12	A	30	29	A	30	29	A	30		
			SPARE				0.63	LIGHT POLES		B	32								
A		4.50					4.12			A	28	A		28	A		28		
B		0.62					2.22			B	30	B		30	B		30		
TOTALS												TOTALS		TOTALS		TOTALS			
							8.64												
							36.02												

6 DETAIL - LIGHT POLE  
N.T.S.

EBENSBURG  
MAIN  
STREET  
DEVELOPMENT  
EBENSBURG BOROUGH  
CAMBRIA COUNTY, PA

PROJECT NAME

EBENSBURG, PA

OWNER

REV. DATE DESCRIPTION  
ISSUE 10/27/03  
PROJECT NO 03-1300-0377  
SCALE  
DRAWN BY BJS  
CHECKED BY BJB

L. Robert Kimball & Associates

SHEET TITLE

ELECTRICAL DETAILS