

\$TIMES\$ PLOTTED: \$DATE\$ D-9012 CAD (02-90) REVISED (10-04) OPERATOR: \$PRNAME\$ FILE NAME: \$FILENAME\$

### SIGNAL ASSEMBLY NOTES:

1. ALL SIGNALS TO BE L.E.D.
2. ALL PEDESTRIAN PUSH BUTTONS MUST BE ADA COMPLIANT.
3. FINAL FLASHING WARNING DEVICE PLACEMENT WILL BE DETERMINED BY A REPRESENTATIVE OF THE DISTRICT TRAFFIC UNIT.
4. PUSH BUTTON TO INCLUDE A CONFIRMATION L.E.D. LIGHT AND TONE.

### OPERATION NOTES:

1. UPON ACTUATION, SIGNALS SHALL FLASH FOR 20 SECONDS.
2. THE ILLUMINATION ELEMENT IN THE YELLOW LENSES SHALL CONSIST OF TWO RAPIDLY FLASHING RECTANGULAR SHAPED YELLOW INDICATIONS AT A RATE OF 75 FLASHING SEQUENCES PER MINUTE USING A SPECIFIED 800-MILLISECOND FLASHING SEQUENCE.
3. THE LIGHT INTENSITY OF THE YELLOW INDICATIONS DURING DAYTIME CONDITIONS SHALL MEET THE MINIMUM SPECIFICATIONS FOR CLASS 1 YELLOW PEAK LUMINOUS INTENSITY IN SAE STANDARD J595.
4. ALL RECTANGULAR FLASHING BEACONS TO BE ACTUATED BY ONE PEDESTRIAN ACTUATION.
5. TO MINIMIZE EXCESSIVE GLARE DURING NIGHT TIME CONDITIONS, AN AUTOMATIC SIGNAL DIMMING DEVICE SHOULD BE USED TO REDUCE THE BRILLIANCE OF THE RRFB INDICATIONS.
6. WHEN RAPID FLASHING BEACON SEQUENCE INITIATES, A PEDESTRIAN CONFIRMATION LIGHT SHALL ILLUMINATE AND AN AUDIBLE MESSAGE "YELLOW LIGHTS ARE FLASHING WAIT FOR VEHICLES TO YIELD" SHALL PLAY TWICE.
7. RRFB SIGNALS SHALL BE DARK UNTIL ACTUATED BY PUSH BUTTON.

### POWER SUPPLY NOTES

1. ELECTRIC SERVICE IS TO BE THE PRIMARY SOURCE OF POWER.

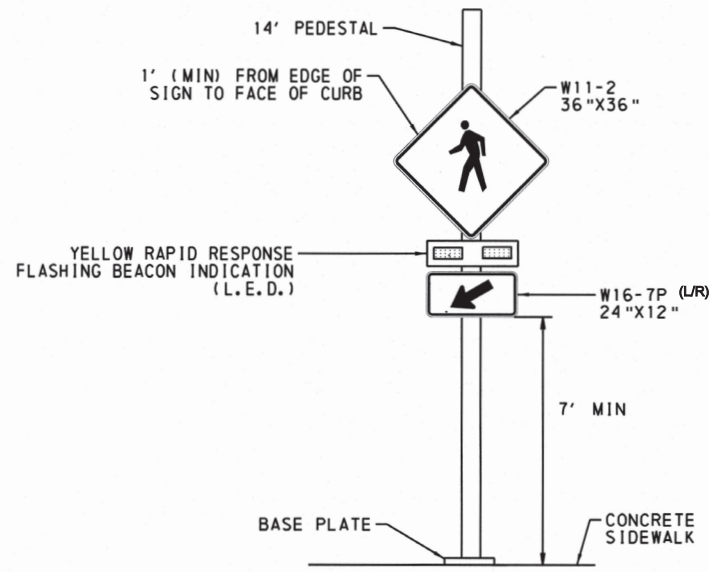

FLASHING BEACON DETAIL

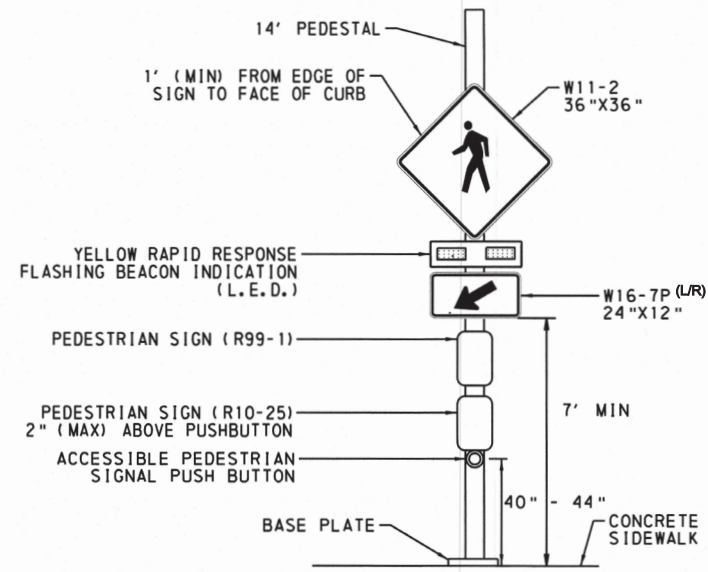

FLASHING BEACON DETAIL

### WIRING DIAGRAM

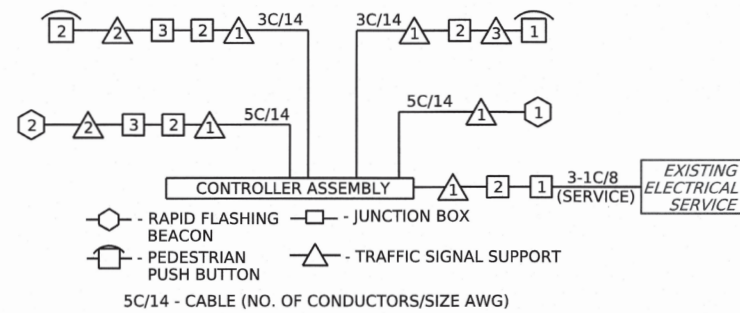

### SIGNS

PLAN SYMBOL	SERIES	DESCRIPTION	SIZE (W X H)
A	W11-2	PEDESTRIAN CROSSING	36" X 36"
B	W16-7P (L)	DIAGONAL DOWNWARD POINTING ARROW (LEFT)	24" X 12"
C	R10-25	PUSH BUTTON TO TURN ON WARNING LIGHTS	9" X 12"
D	R99-1	WAIT FOR VEHICLES TO YIELD BEFORE CROSSING	9" X 12"
E	W16-7P (R)	DIAGONAL DOWNWARD POINTING ARROW (RIGHT)	24" X 12"

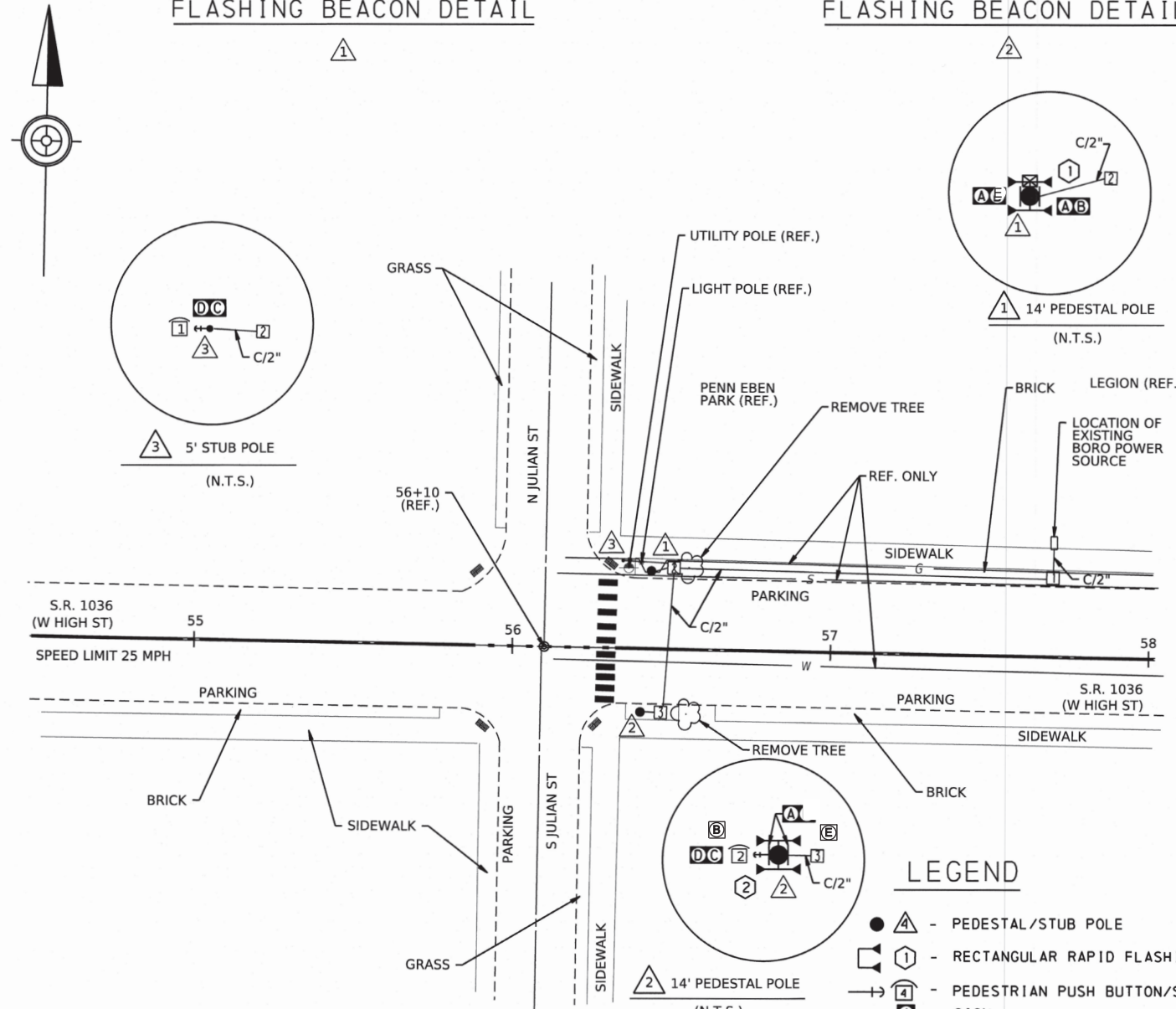

### LEGEND

- ▲ - PEDESTAL/STUB POLE
- - RECTANGULAR RAPID FLASHING BEACON
- - PEDESTRIAN PUSH BUTTON/SIGN
- ▲ - SIGN
- ⊗ - CONTROLLER ASSEMBLY
- - JUNCTION BOX
- C/2" - CONDUIT/SIZE
- - EXISTING BOROUGH POWER SOURCE

DISTRICT	COUNTY	ROUTE	SECTION	SHEET
9-0	CAMBRIA	1036	---	1 OF 2

BOROUGH OF EBENSBURG

PERMIT NO. W9-3-58 SHEET 2 OF 2  
 DATE ISSUED 03/07/2024 DATE REVISED

### GENERAL NOTES

INSTALL, OPERATE AND MAINTAIN THIS TRAFFIC SIGNAL IN ACCORDANCE WITH PENNSYLVANIA DEPARTMENT OF TRANSPORTATION REGULATIONS ON OFFICIAL TRAFFIC CONTROL DEVICES.

NO MODIFICATION OF THIS INSTALLATION IS PERMITTED UNLESS PRIOR APPROVAL IS GRANTED, IN WRITING, BY THE DEPARTMENT.

ALL MAINTENANCE NECESSARY FOR PROPER VISIBILITY OF THE SIGNALS, INCLUDING TRIMMING TREES, IS THE RESPONSIBILITY OF THE PERMITTEE.

THE PERMITTEE INSTALLS AND MAINTAINS ALL SIGNS AND PAVEMENT MARKINGS INDICATED ON THIS DRAWING WHICH ARE CONSIDERED PART OF THE PERMIT, UNLESS OTHERWISE INDICATED. THE DEPARTMENT MAINTAINS THE LONGITUDINAL PAVEMENT MARKINGS ON STATE HIGHWAYS.

INSTALL POST MOUNTED SIGNALS WITH THE SIGNAL HEADS A MINIMUM OF 2 FEET BEHIND THE FACE OF THE CURB OR EDGE OF THE SHOULDER. ALSO, INSTALL SUPPORT POLES FOR OVERHEAD SIGNALS WITH A MINIMUM HORIZONTAL CLEARANCE OF 2 FEET.

INSTALL POST MOUNTED SIGNAL HEADS WITH BOTTOMS NOT LESS THAN 8 FEET NOR MORE THAN 15 FEET ABOVE THE SIDEWALK OR PAVEMENT GRADE.

IN ADDITION TO THIS SIGNAL PERMIT, THE PERMITTEE MUST OBTAIN A HIGHWAY OCCUPANCY PERMIT PRIOR TO ANY OPENINGS BEING MADE IN OR UNDER ANY PORTION OF A STATE HIGHWAY.

THIS DRAWING CANNOT BE USED AS A CONSTRUCTION DRAWING UNLESS THE PERMITTEE COMPLIES WITH THE PROVISIONS OF ACT 172, PREVENTION OF DAMAGE TO UNDERGROUND UTILITIES. PRIOR TO CONSTRUCTION PERFORM PA ONECALL AND CONSULT WITH UTILITY COMPANIES TO RESOLVE ANY PROBLEMS WHICH MAY BE CREATED DUE TO THE LOCATION OF UTILITIES.

PAVEMENT MARKINGS SHALL BE PLACED IN ACCORDANCE WITH THE DEPARTMENT OF TRANSPORTATION PAVEMENT MARKING HANDBOOK.

PERMITTEE IS RESPONSIBLE FOR OBTAINING APPROVAL FOR INSTALLATION OF TRAFFIC SIGNAL DEVICES LOCATED OUTSIDE HIGHWAY RIGHT-OF-WAY.

EXACT LOCATION OF TRAFFIC SIGNAL SUPPORTS AND DETECTORS SHALL BE DETERMINED PRIOR TO INSTALLATION BY A REPRESENTATIVE OF THE TRAFFIC UNIT.

OBTAIN APPROVAL FROM PENNDOT FOR ALL SIGNAL EQUIPMENT PRIOR TO INSTALLATION. FOLLOW ALL TC-8800 SERIES STANDARDS (PUB. 148).

RESTORE ALL DISTURBED AREAS SURROUNDING POLE EXCAVATIONS, TRENCHES, AND JUNCTION BOXES TO PRE-EXISTING CONDITIONS INCLUDING LANDSCAPING AND VEGETATION.

ALL WIRE RUNS SHALL BE CONTINUOUS. NO SPLICING IS PERMITTED.

UPDATED W16-7P SIGNAGE

COUNTY: CAMBRIA

MUNICIPALITY: BOROUGH OF EBENSBURG

INTERSECTION: SR 1036 (W HIGH STREET) & JULIAN STREET

REVIEWED: [Signature] 3-5-2024  
 MUNICIPAL OFFICIAL DATE

RECOMMENDED: [Signature] 01/12/2024  
 DISTRICT TRAFFIC ENGINEER DATE

SCALE: 0 25 50 FEET

# TRAFFIC SIGNAL TABULATION

DISTRICT	COUNTY	ROUTE	SECTION	SHEET	
9-0	CAMBRIA	1036	---	2 OF 2	
BOROUGH OF EBENSBURG					
REVISION NUMBER	REVISIONS			DATE	BY

S.R. 1036 (W HIGH ST) &  
JULIAN ST PEDESTRIAN CROSSING

## SIGNS

PLAN SYMBOL	DESCRIPTION	SIZE	SQ FT EA	QUANTITY	POST MOUNTED SIGNS, TYPE F		
					0935 0001 SF		
A	W11-2, PEDESTRIAN CROSSING	36"X36"	9.00	4.0	36.00		
B	W16-7(L) W16-7P, DIAGONAL DOWNWARD POINTING ARROW (LEFT)	24"X12"	2.00	4.0	4.00	8.00	
C	R10-25, PUSH BUTTON TO TURN ON WARNING LIGHTS	9"X12"	0.75	2.0	*		
D	R99-1, WAIT FOR VEHICLES TO YIELD BEFORE CROSSING	9"X12"	0.75	2.0	1.50		
E	W16-7(R), DIAGONAL DOWNWARD POINTING ARROW (RIGHT)			2.0	4.00		
TOTALS					45.50		

\* - INCLUDED IN ITEM FOR PEDESTRIAN PUSHBUTTON

ITEM NUMBER	MISCELLANEOUS			
UNIT	DESCRIPTION	QUAN.	LOCATION	REMARKS
0810 0025 EACH	SELECTIVE TREE TRIMMING	2		APPROX. 12' EAST OF ① & ②
0935 0424 EACH	RECTANGULAR RAPID FLASHING BEACON ASSEMBLY WITH ACCESSIBLE PEDESTRIAN SIGNAL (DOUBLE SIDED)	2	① & ②	TO PLAY AUDIBLE MESSAGE AS INDICATED IN PLAN NOTES
0956 0500 EACH	PEDESTRIAN PUSH BUTTON	2	② & ③	① & ②

## TRAFFIC SIGNAL SUPPORTS\*

STRUCTURE NUMBER	ITEM NUMBER	DESCRIPTION	QUAN.	ROUTE	STATION	SIDE	OFFSET	PEDESTAL		
								SHAFT SIGNALS		
								H	M	N
①	4951 4106 EACH	TRAFFIC SIGNAL SUPPORT, 14' PEDESTAL, POWDER COATED, BLACK, CLAM SHELL BASE	1	SR 1036	56+43	LT	24.5	14		
②	4951 4106 EACH	TRAFFIC SIGNAL SUPPORT, 14' PEDESTAL, POWDER COATED, BLACK, CLAM SHELL BASE	1	SR 1036	56+40	RT	20	14		
③	4951 4112 EACH	PEDESTRIAN STUB POLE, TYPE B, POWDER COATED, BLACK, CLAM SHELL BASE	1	SR 1036	56+34	LT	27.5			

\* - REFER TO TRAFFIC STANDARDS - SIGNALS, TC-8800, FOR LETTER DESIGNATIONS

## TRENCH, CONDUIT, JUNCTION BOX, ELECTRICAL ITEMS

DESCRIPTION	LOCATION	ITEM NUMBER	UNIT	0954 0012 LF		0954 0152 LF		0954 0153 LF		0910 4116 LF		0954 0201 LF		0954 0202 LF		0954 0300 EACH	9000 0001 LS
				2 INCH CONDUIT		TRENCH AND BACKFILL, TYPE II		TRENCH AND BACKFILL, TYPE III		AWG 8 UNDERGROUND CABLE, COPPER, 1 CONDUCTOR		SIGNAL CABLE, 14 AWG, 3 CONDUCTOR		SIGNAL CABLE, 14 AWG, 5 CONDUCTOR			
	① - ②		10		10												
	② - ①		125		125												
	① - ①		15		15												
	② - ③		20		20												
	② - ③		55		55												
	③ - ②		10		10												
	① - SR 1036 STA 57+70 LT															1	
	② - SR 1036 STA 56+50 LT															1	
	③ - SR 1036 STA 56+47 RT															1	
	SR 1036 STA 57+70 LT																1
	W HIGH ST (SR 1036) & JULIAN ST SEE WIRING DIAGRAM									510	160	130					
TOTALS			235		180	55				510	160	130				3	1

## TRAFFIC SIGNAL PLAN